

PLANS FOR THE CONSTRUCTION OF THE WEST MAIN STREET STREETScape IMPROVEMENTS (PHASE 3 WILLOW STREET CORRIDOR)

- LOCATED AT -

WEST MAIN STREET (S.R. 68 & 70) TO #31 WILLOW STREET CHESHIRE, CONNECTICUT

- PREPARED FOR THE TOWN OF CHESHIRE -

DEPARTMENT OF PUBLIC WORKS
84 SOUTH MAIN STREET, CHESHIRE, CT 06410

FINAL TOWN REVIEW SET - 09 SEPTEMBER, 2022

GENERAL NOTES FOR CONSTRUCTION

- CONTRACTOR SHALL CONTACT "CALL-BEFORE-YOU-DIG" SERVICES AT 1-800-922-4455 A MINIMUM OF TWO (2) DAYS BEFORE BEGINNING ANY EXCAVATION AT THE SITE.
- CONTRACTOR IS RESPONSIBLE FOR ANY DAMAGE DUE TO CONSTRUCTION OPERATIONS WITHIN AND OUTSIDE OF THE LIMITS OF CONSTRUCTION AS SHOWN ON THE PLANS.
- NEW WORK SHALL BLEND SMOOTHLY WITH EXISTING GRADES. UNLESS OTHERWISE SHOWN, ALL PAVEMENTS SHALL HAVE A TWO PERCENT CROSS-PITCH TO INSURE PROPER DRAINAGE.
- ALL DISTURBED AREAS WITHIN OR OUTSIDE THE LIMITS OF CONSTRUCTION NOT COVERED BY BUILDINGS, PAVEMENT, PLANTING BEDS OR OTHER IMPROVEMENTS ARE TO BE TOPSOILED (4" DEPTH MIN.) AND SEEDED PER DIRECTION OF THE OWNER.
- SILTATION AND EROSION CONTROL MEASURES SHALL BE INSTALLED AS NECESSARY PRIOR TO THE START OF GRADING AND MAINTAINED UNTIL ALL GROUND SURFACES ARE STABILIZED, I.E. WITH TURF, PAVEMENTS, ETC.
- ANY DIMENSION LINE SHOWN FROM PROPERTY LINE, FACE OF CURB OR BUILDING IS PERPENDICULAR UNLESS OTHERWISE SHOWN.
- PROTECT EXISTING UTILITIES TO REMAIN FROM DAMAGE. ACTIVE UTILITY LINES DAMAGED DURING CONSTRUCTION OPERATIONS SHALL BE REPAIRED OR REPLACED AS DIRECTED BY THE UTILITY OWNER AT NO ADDITIONAL COST TO THE OWNER. THE CONTRACTOR SHALL FAMILIARIZE HIMSELF WITH ALL SUBSURFACE UTILITIES PRIOR TO THE START OF WORK. ANY FIELD CONDITIONS THAT DIFFER FROM THE PLANS SHALL BE BROUGHT TO THE ATTENTION OF THE ENGINEER IMMEDIATELY.
- PROVIDE, ERECT AND MAINTAIN BARRICADES, WARNING LIGHTS, SIGNS, ETC., AS REQUIRED FOR SAFETY OF PERSONNEL, PUBLIC AND OCCUPANTS OF THE FACILITIES AFFECTED BY THE CONTRACTOR'S OPERATIONS. CONTRACTOR SHALL MAINTAIN TRAFFIC ACCESS AND EGRESS PATTERNS AS DIRECTED BY THE OWNER'S REPRESENTATIVE AND IN ACCORDANCE WITH CTDOT STANDARDS.
- ALL MATERIALS AND METHODS OF CONSTRUCTION SHALL CONFORM TO CTDOT FORM 818, LATEST EDITION, AS AMENDED, UNLESS OTHERWISE SHOWN ON THE DRAWINGS OR SPECIFIED HEREIN.
- THE CONTRACTOR SHALL CAREFULLY SAWCUT EXISTING CURBS AND PAVEMENTS PRIOR TO REMOVAL. ALL EXISTING CURBING, PAVEMENTS AND OTHER AMENITIES THAT MAY INTERFERE WITH THE NEW WORK SHALL BE BROUGHT TO THE ATTENTION OF THE OWNER'S REPRESENTATIVE.
- COMPACT MATERIAL TO NOT LESS THAN THE MAXIMUM DRY DENSITY IN ACCORDANCE WITH ASTM D-1557 AND D-2049 AS FOLLOWS:
 - FOR UNPAVED AREAS, COMPACT TOP 6" OF SUBGRADE AND EACH LAYER OF BACKFILL OF FILL MATERIAL TO 85% MAXIMUM DRY DENSITY.
 - FOR PAVEMENTS, COMPACT TOP 12" OF SUBGRADE AND EACH LAYER OF BACKFILL MATERIAL TO 95% MAXIMUM DRY DENSITY.
- ALL UNSUITABLE MATERIAL SHALL BECOME THE PROPERTY OF THE CONTRACTOR AND SHALL BE REMOVED FROM THE SITE AND DISPOSED OF IN ACCORDANCE WITH ALL LOCAL, STATE AND FEDERAL LAWS.
- REPAIR ALL DAMAGED LAWN AREAS WITH MINIMUM 4" TOPSOIL, SEED & MULCH. GRADE AS DIRECTED BY TOWN ENGINEER.

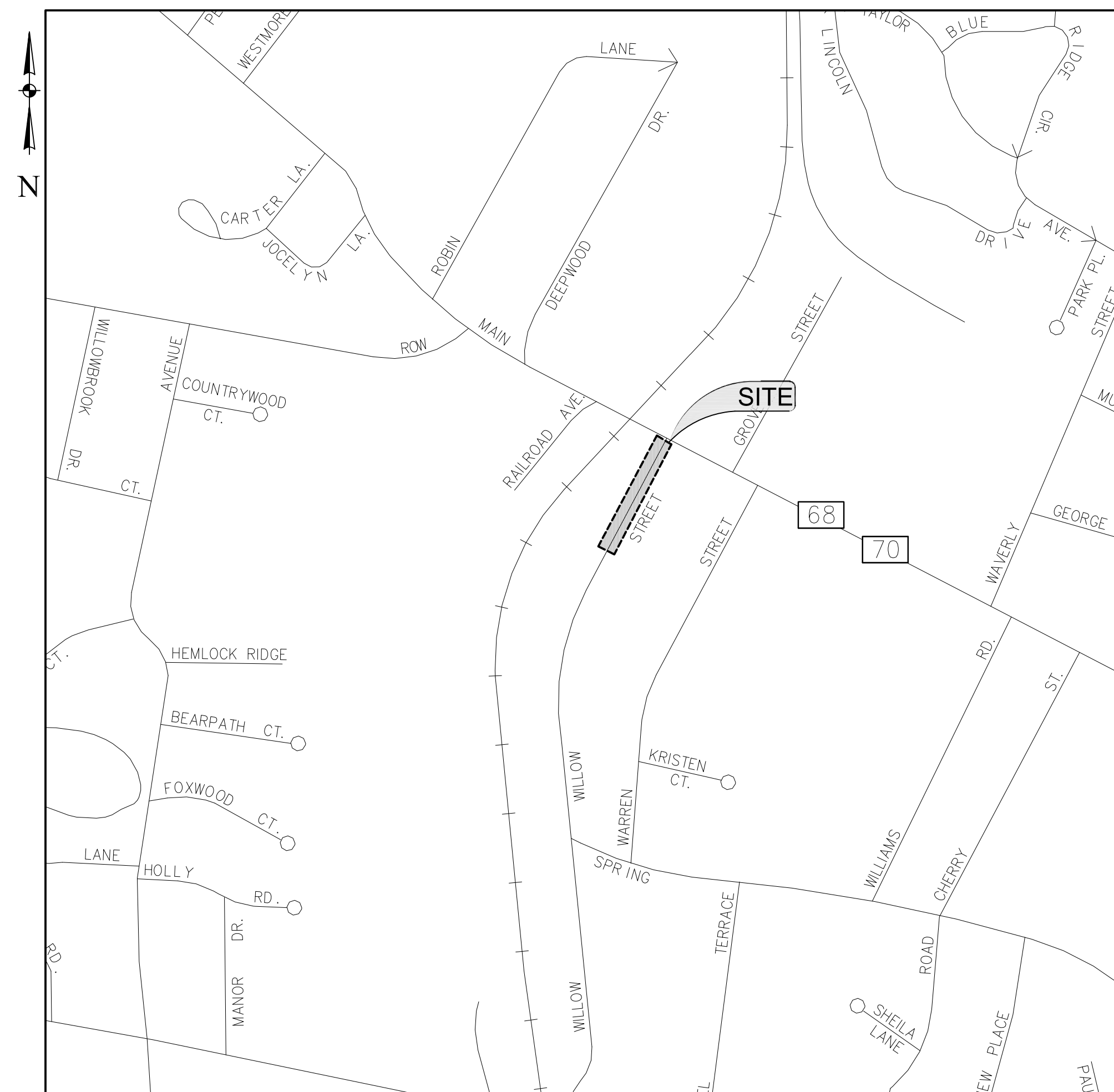

SITE LOCATION MAP
SCALE: 1"=500'

LIST OF DRAWINGS

SITE DEVELOPMENT PLANS	DATE	REVISED
-- Title Sheet	09-09-2022	
01 Proposed Sidewalk Plan	09-09-2022	
02 Typical Site Details	09-09-2022	
03 Traffic Control Details	09-09-2022	
04 Streetscape Detail Plan	09-09-2022	
05 Streetscape Details	09-09-2022	

SURVEY NOTES

- SURVEY INFORMATION BASED ON FIELD SURVEY PERFORMED BY OCC GROUP, INCORPORATED IN AUGUST, 2022, AND DEPICTS CONDITIONS FOUND AT THE TIME OF THE SURVEY.
- ELEVATIONS ARE BASED ON THE NORTH GEODETIC VERTICAL DATUM OF 1929 (29NGVD).
- THE UNDERGROUND UTILITIES SHOWN HAVE BEEN LOCATED FROM FIELD SURVEY INFORMATION AND EXISTING DRAWINGS. OCC GROUP, INCORPORATED MAKES NO GUARANTEE THAT THE UNDERGROUND UTILITIES SHOWN COMPRISE ALL SUCH UTILITIES IN THE AREA, EITHER IN SERVICE OR ABANDONED. OCC GROUP, INCORPORATED FURTHER DOES NOT WARRANT THAT THE UNDERGROUND UTILITIES SHOWN ARE IN THE EXACT LOCATION INDICATED ALTHOUGH IT IS CERTIFIED THAT THEY ARE LOCATED AS ACCURATELY AS POSSIBLE FROM INFORMATION AVAILABLE. OCC GROUP, INCORPORATED HAS NOT PHYSICALLY LOCATED THE UNDERGROUND UTILITIES.

CALL BEFORE YOU DIG

ALL UTILITY AND SUB-SURFACE INFORMATION SHOWN HEREON IS TO BE CONSIDERED APPROXIMATE BOTH AS TO SIZE AND LOCATION. THE CONTRACTOR SHALL MAKE INVESTIGATIONS IN THE FIELD TO VERIFY ALL EXACT UTILITY LOCATIONS BEFORE CONSTRUCTION. CALL TELEPHONE 1-800-922-4455 "CALL BEFORE YOU DIG" A MINIMUM OF 2 DAYS BEFORE BEGINNING ANY EXCAVATION AT THE SITE.

CIVIL ENGINEERING CONSULTANT:

LANDSCAPE ARCHITECT CONSULTANT:



ENGINEERS & SURVEYORS

78 ELM STREET, BRIDGEPORT, CT 06604
P: 203 330 8700 • F: 203 330 8701



78 Elm Street
Bridgeport, CT 06604
www.arisls.com
203.606.3130

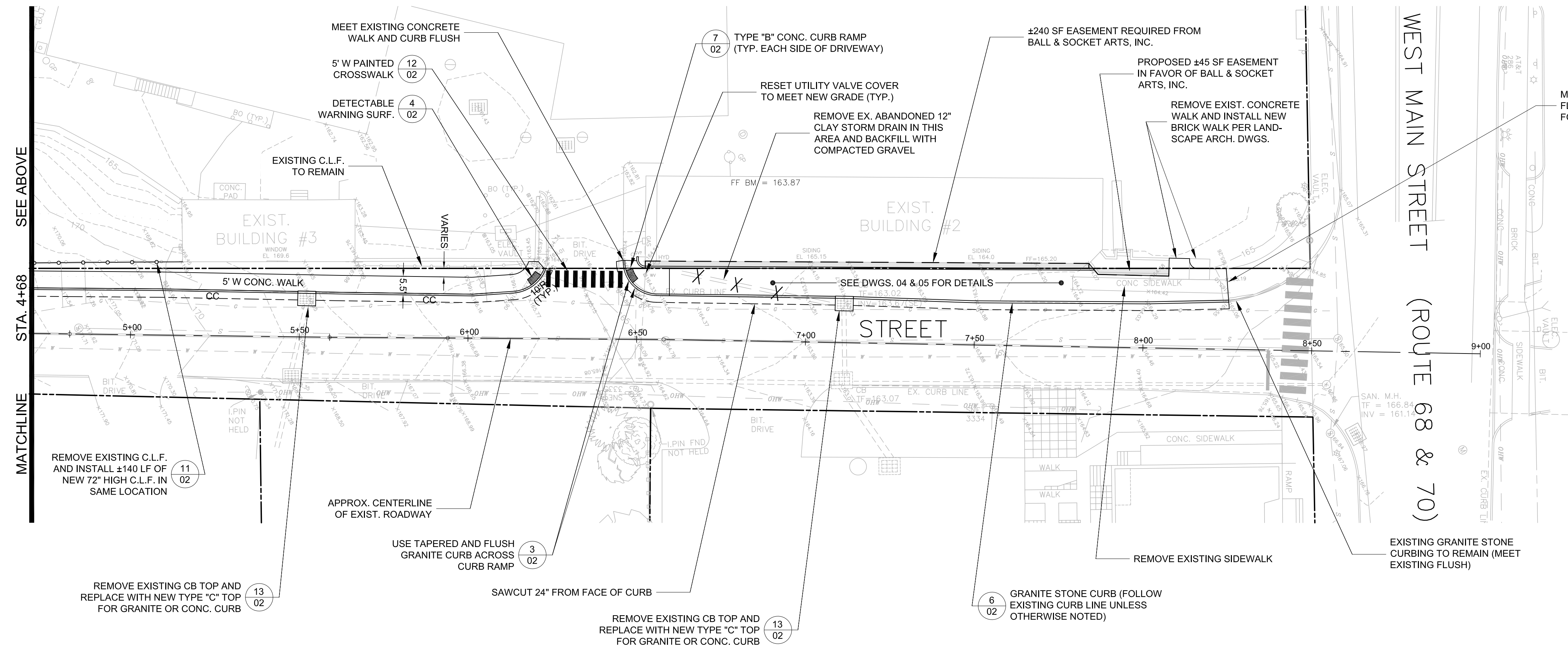
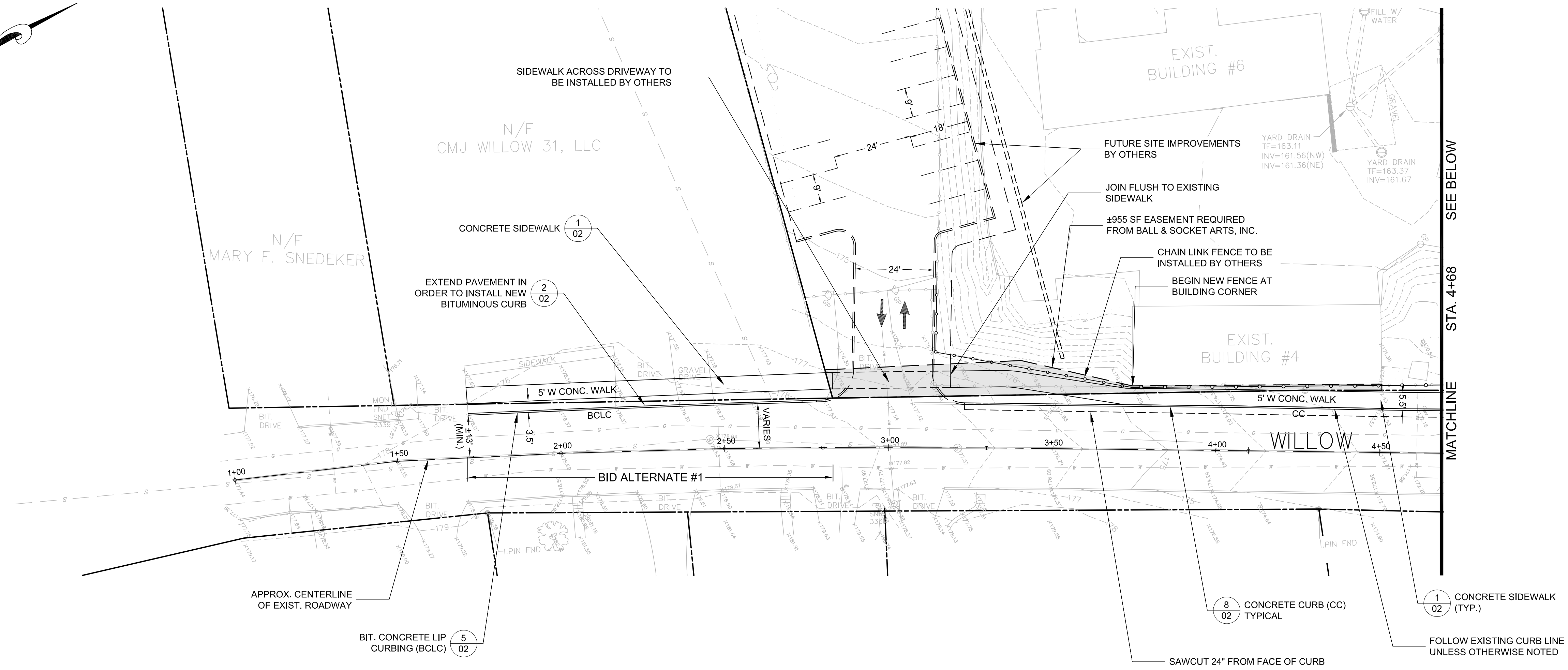
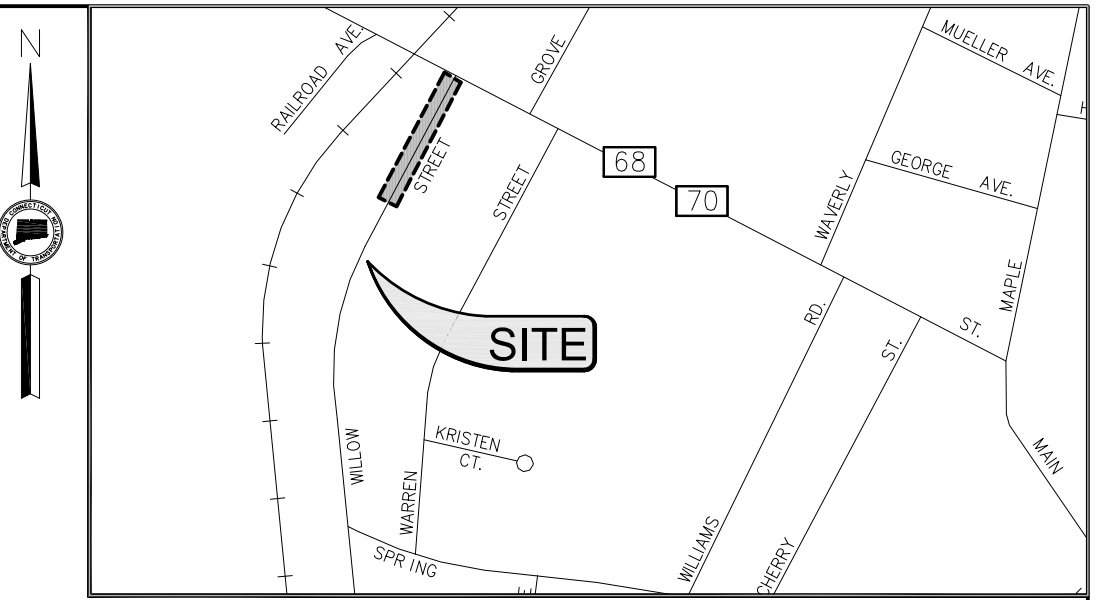
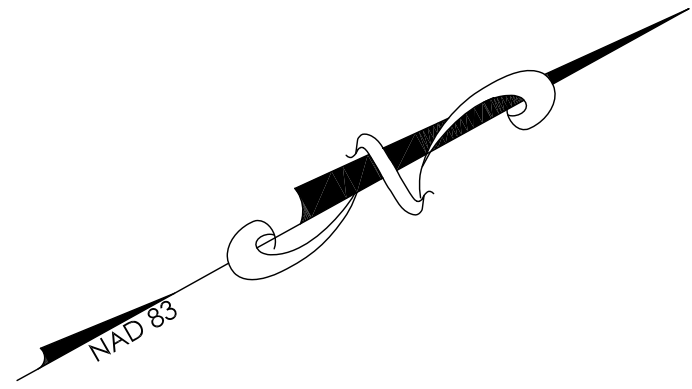

LEGEND AND ABBREVIATIONS

---	PROPERTY LINE
---	PROPOSED EASEMENT
---	SAWCUT LIMITS
99	CONTOUR (EX.)
x 99	SPOT ELEV. (EX.)
-99	CONTOUR (PROP.)
+ 99	SPOT ELEV. (PROP.)
V.I.F.	VERIFY IN FIELD
TF	TOP OF FRAME
BIT.	BITUMINOUS
CC	CONCRETE CURB
BCLC	BITUMINOUS CONCRETE LIP CURB
⊙	MANHOLE (D=STORM DRAIN, S=SAN.)

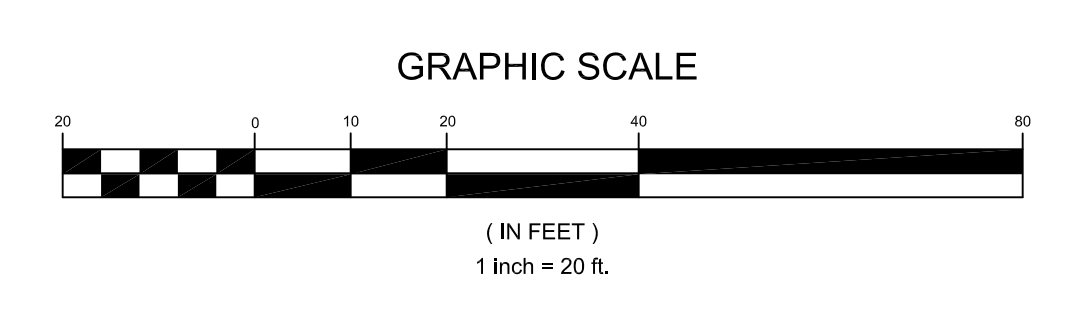

ENGINEERING CONSULTANT:

78 ELM STREET, BRIDGEPORT, CT 06604
P:203 330 8700 • F:203 330 8701

APPROVED BY:

MAREK KEMENT, P.E.
DIRECTOR OF ENGINEERING

WEST MAIN STREET (S.R. 68 & 70)
STREETSCAPE IMPROVEMENTS PROJECT
(PHASE 3 - WILLOW STREET CORRIDOR)
FROM WEST MAIN STREET TO #31 WILLOW STREET
DEPARTMENT OF PUBLIC WORKS
CHESHIRE, CONNECTICUT

DESIGNED CAD DRAWN CAD CHECKED CAD SCALE 1" = 20'-0" DATE 09-09-2022

DRAWING NO. **01**

JOB NO. 22.16

CONTRACT NO. _____

SHEET 1 OF 5 SHEETS

TOWN OF CHESHIRE

PROPOSED SIDEWALK PLAN

DEPARTMENT OF PUBLIC WORKS

NO.	DESCRIPTION	DATE

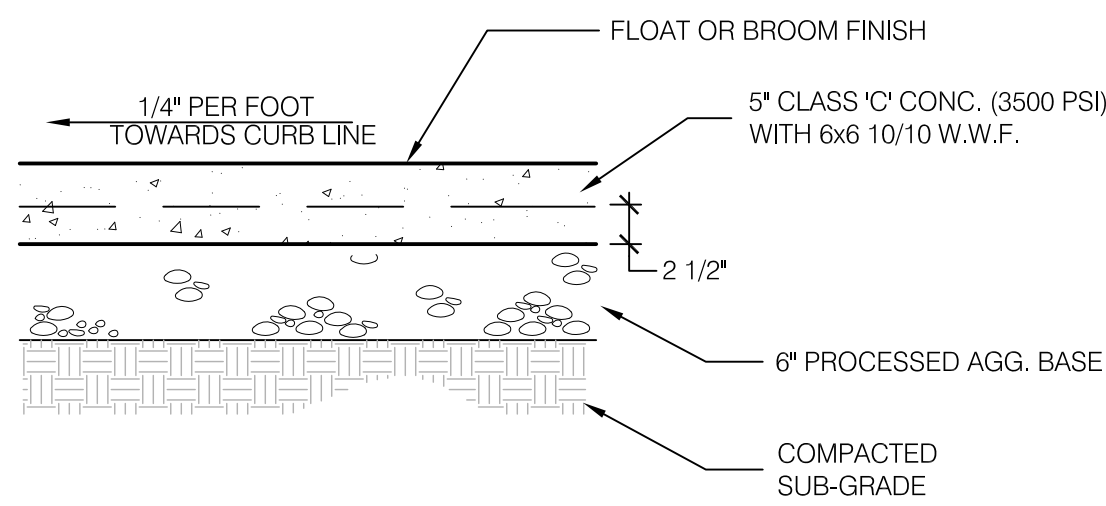

1 CONCRETE SIDEWALK
SCALE: N.T.S.

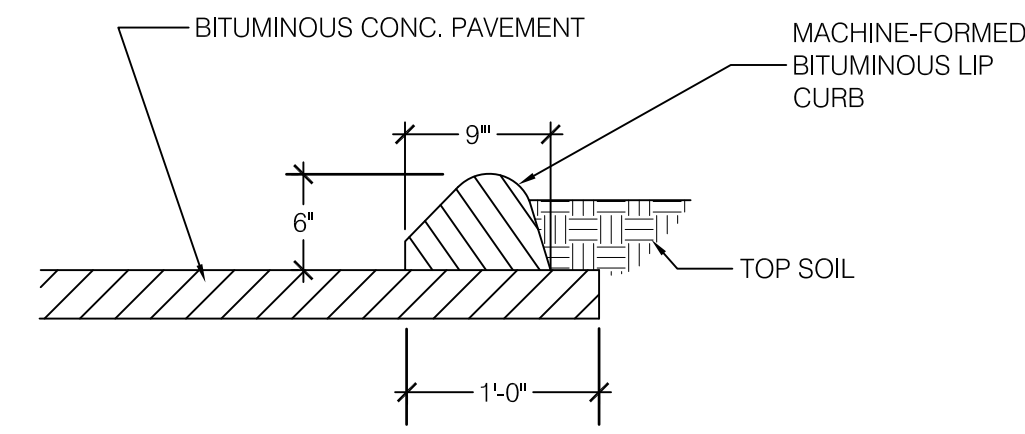

5 BITUMINOUS LIP CURB - 6\"/>

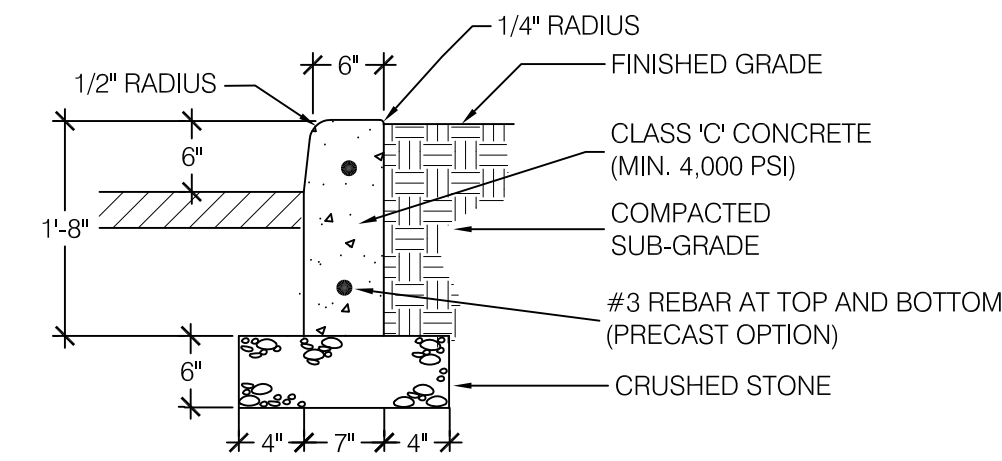

8 CONCRETE CURB
SCALE: N.T.S.

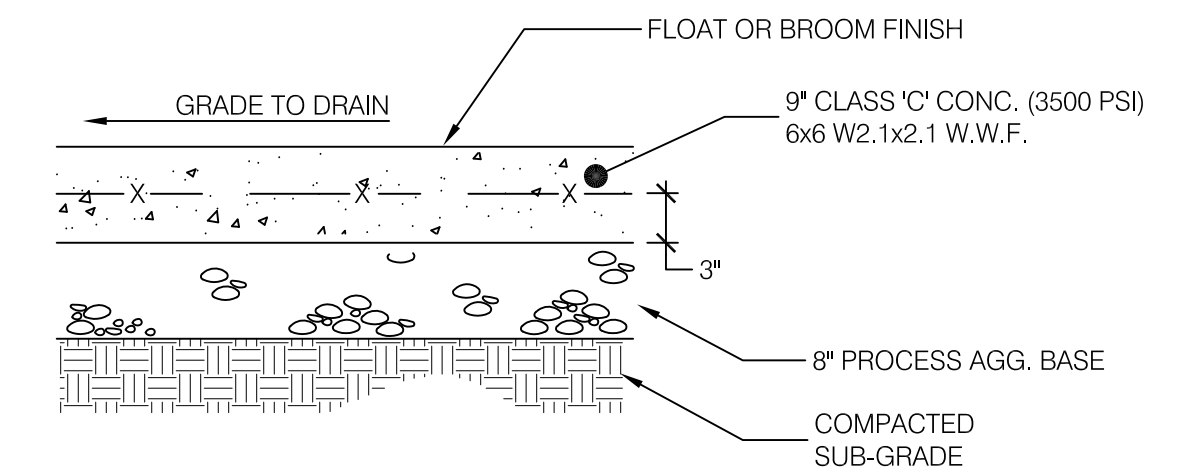

10 CONCRETE SIDEWALK (HEAVY DUTY)
SCALE: N.T.S.

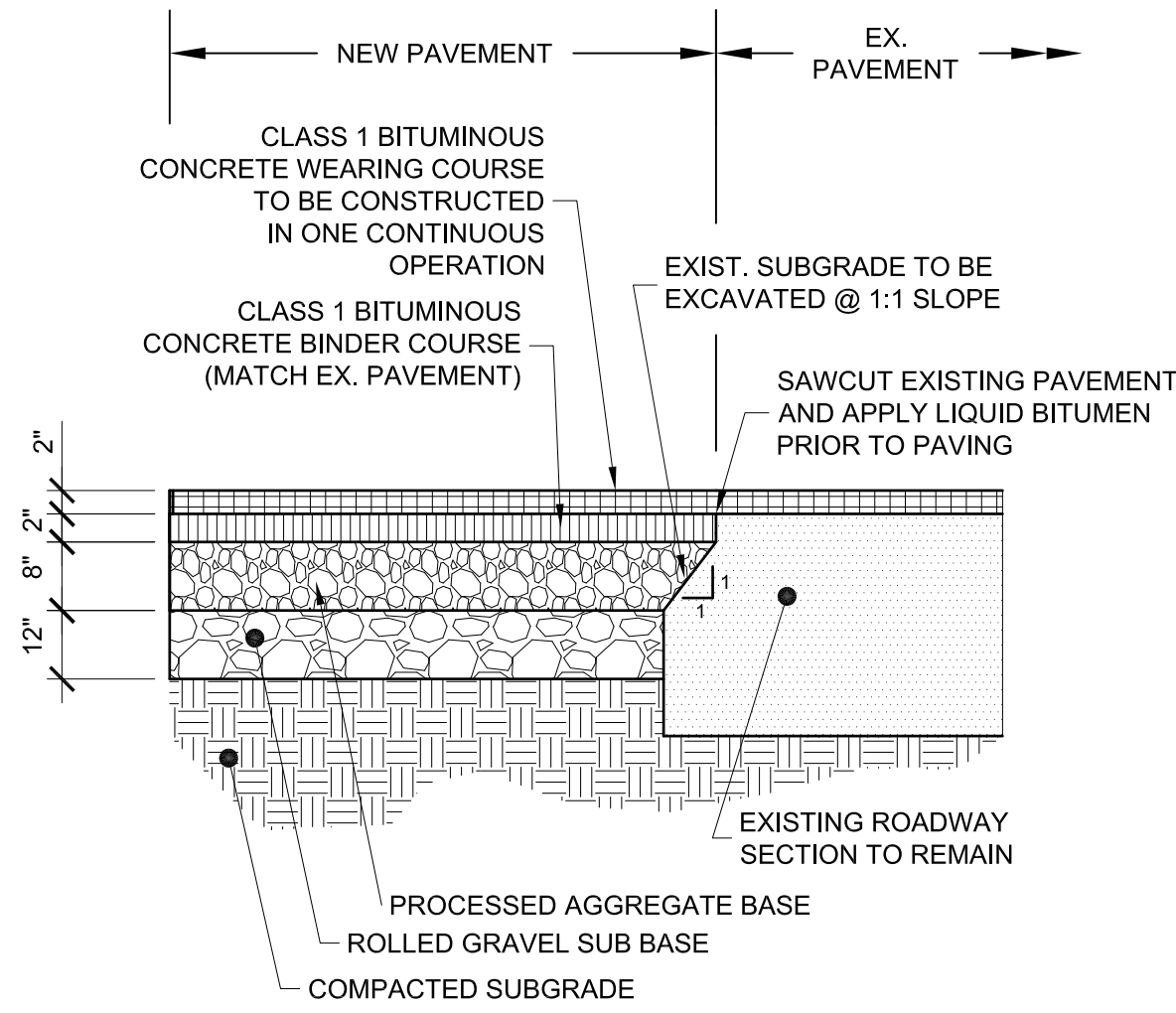

2 FULL DEPTH PAVEMENT @ PAVEMENT EXTENSION
SCALE: N.T.S.

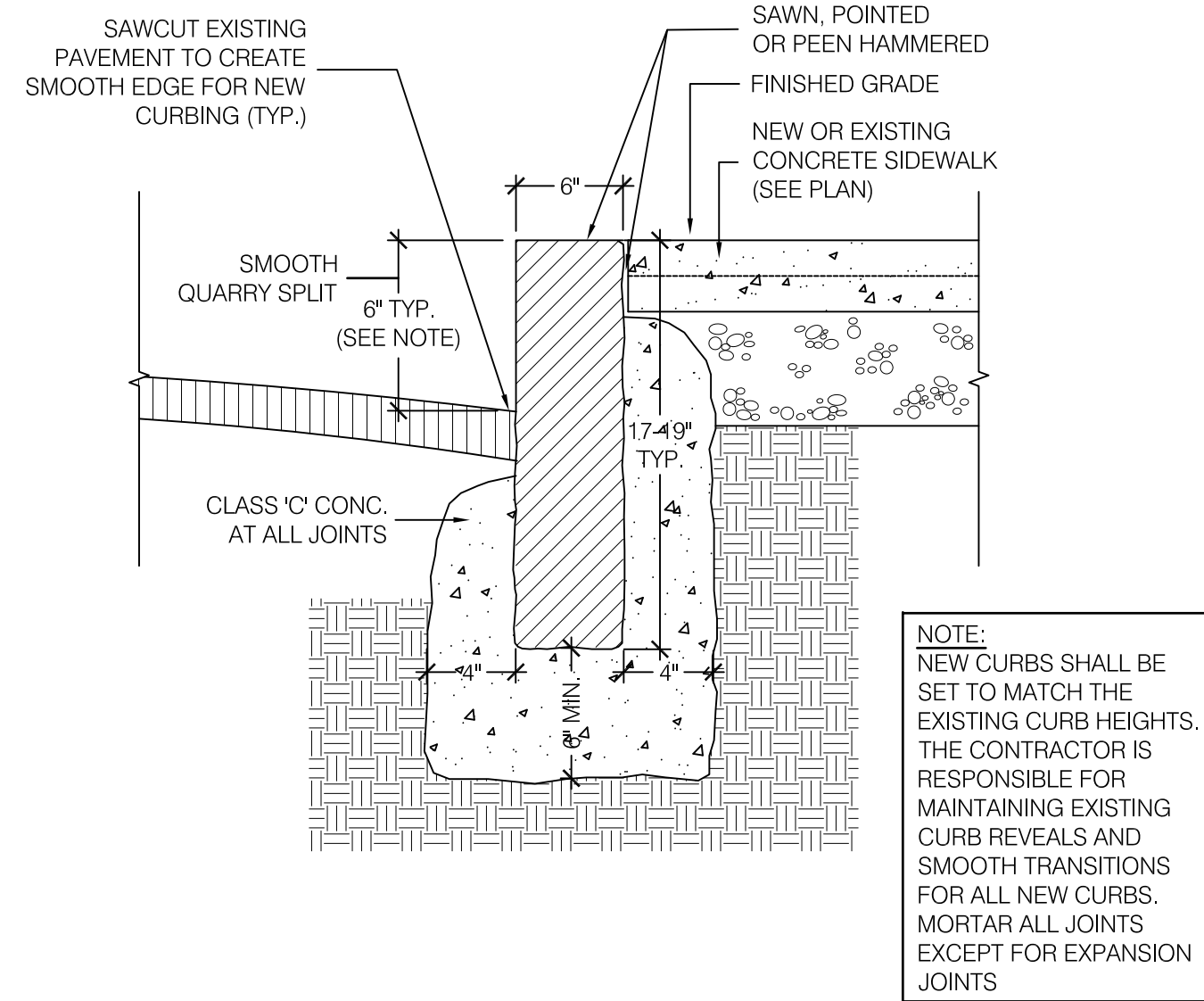

6 GRANITE CURB
SCALE: N.T.S.

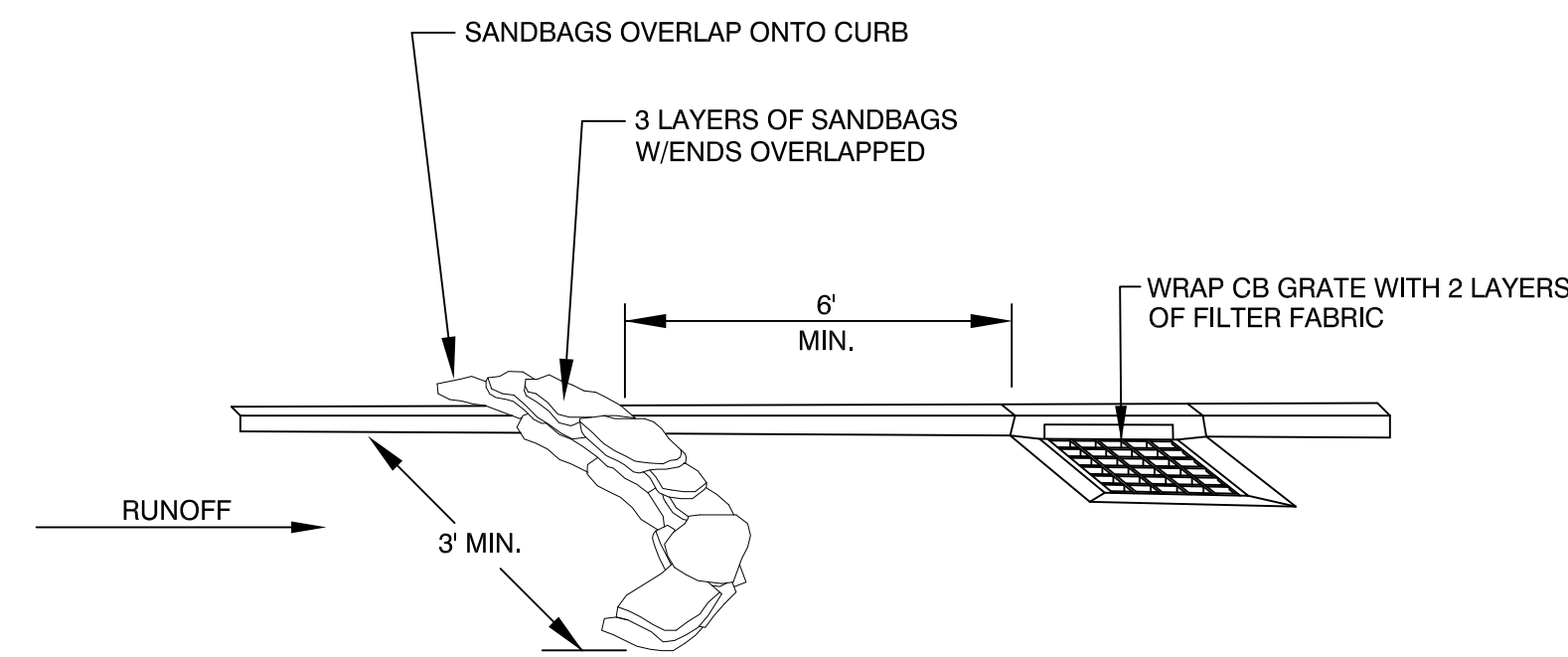

9 SAND BAG CURB INLET SEDIMENT BARRIER
SCALE: N.T.S.

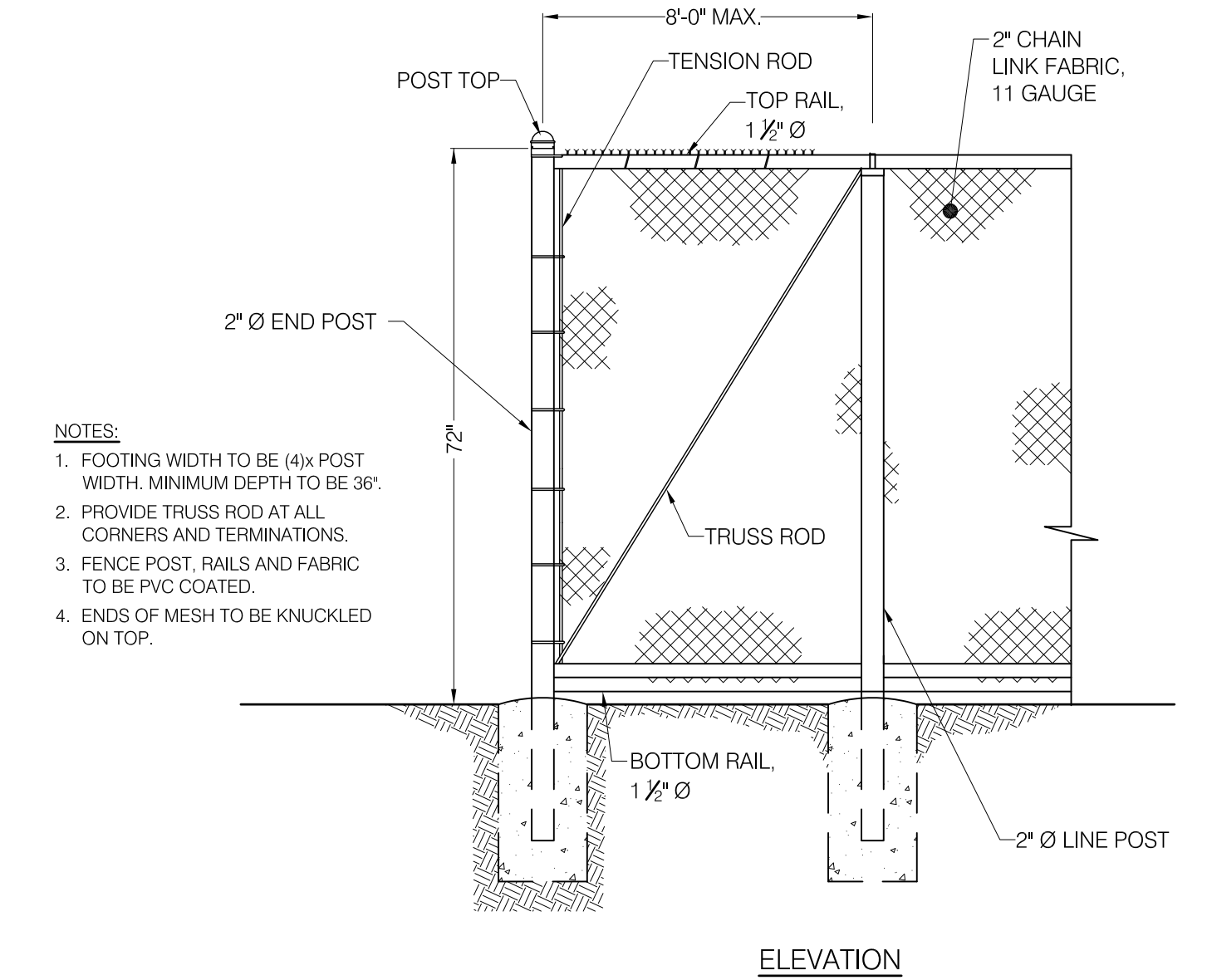

11 6\"/>

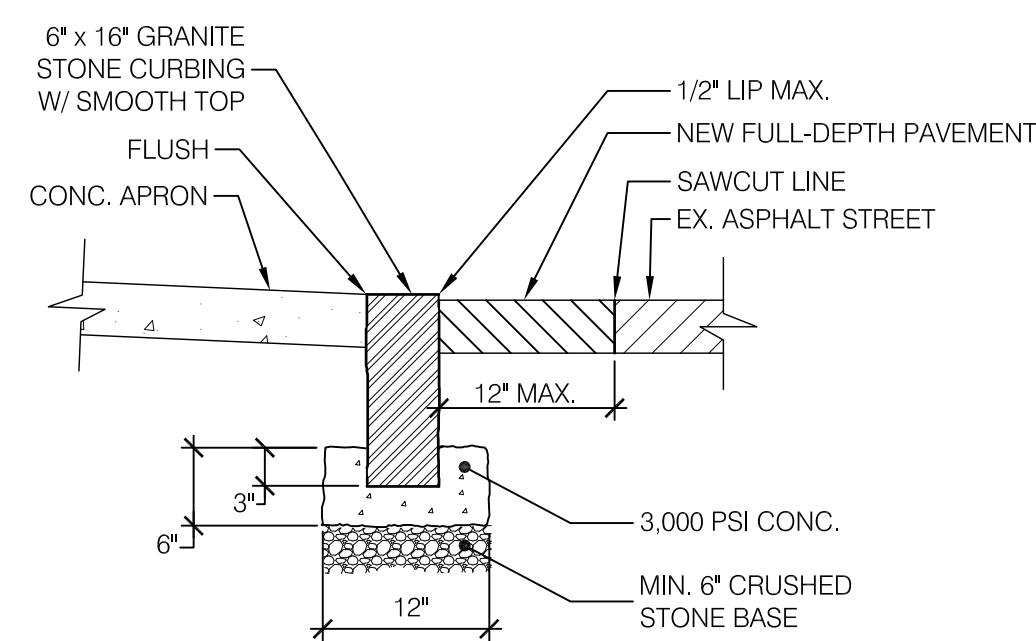

3 GRANITE HEADER CURB
SCALE: 1\"/>

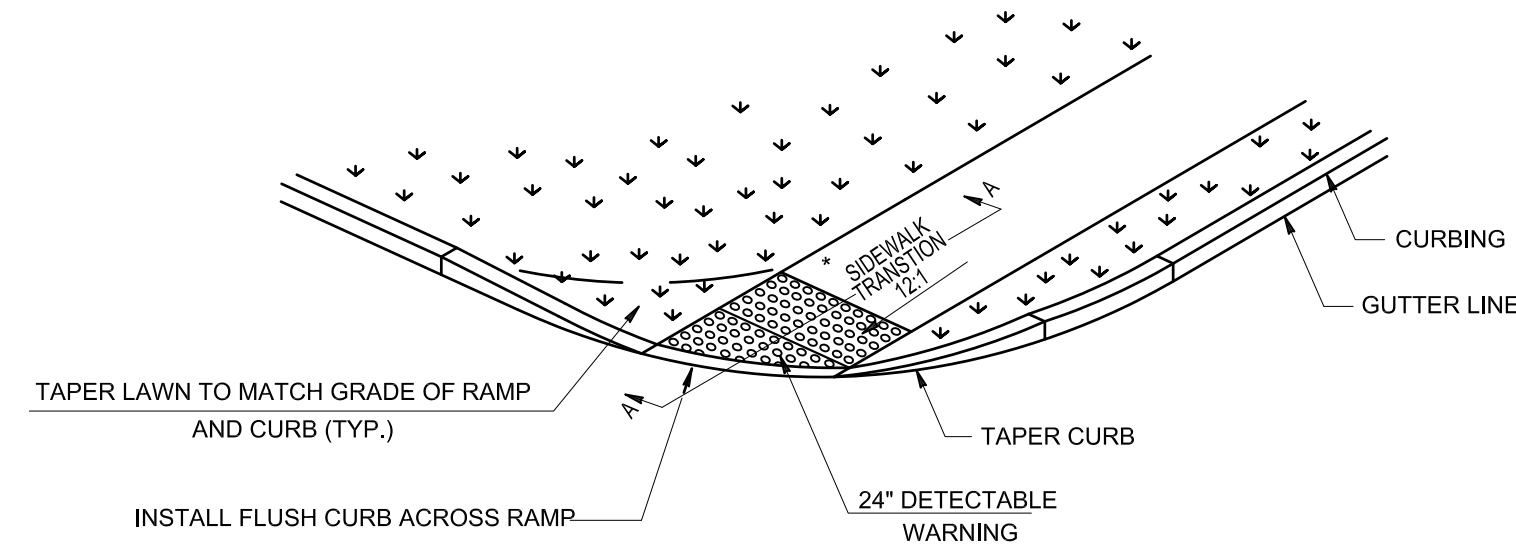

TYPE A - STRAIGHT TYPE WITH GRASS STRIP

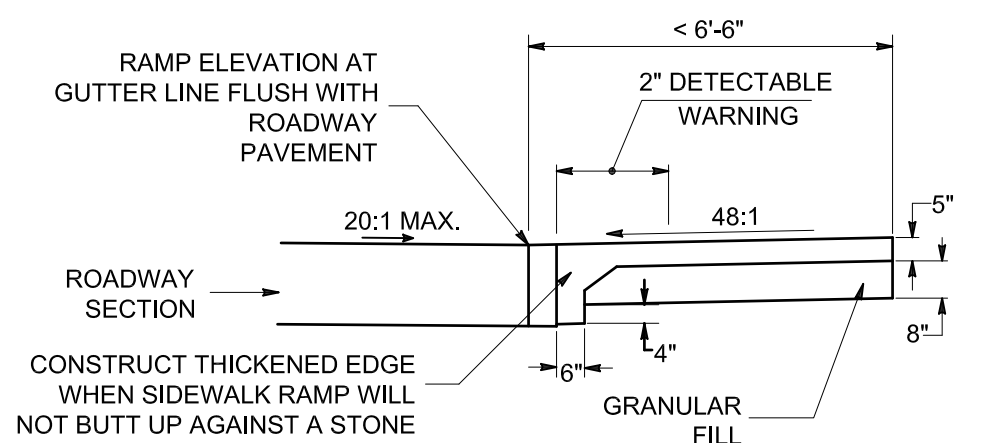

LONGITUDINAL SECTION A-A

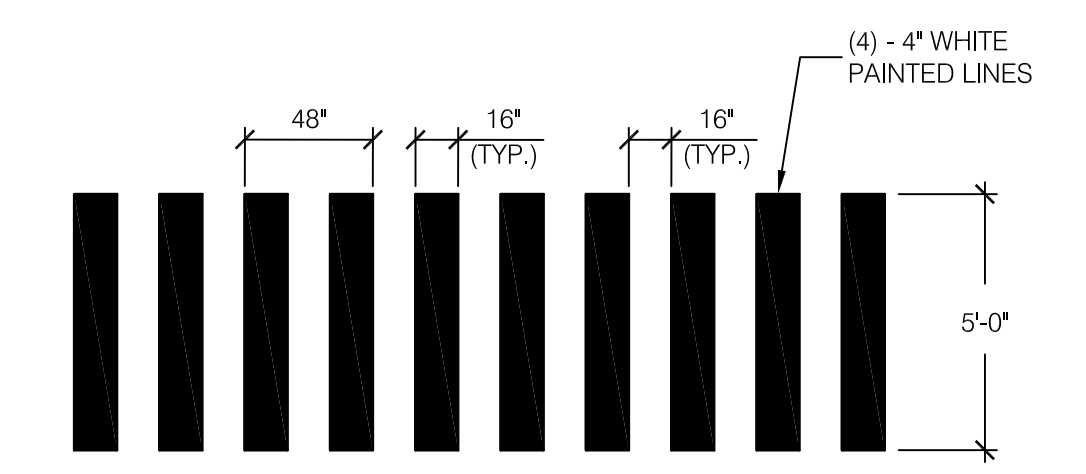

NOTE: CROSS SLOPE NOT TO EXCEED 2% (50:1). SLOPE IN THE DIRECTION OF TRAVEL NOT TO EXCEED 5% (20:1).

12 CROSSWALK STRIPING
NOT TO SCALE

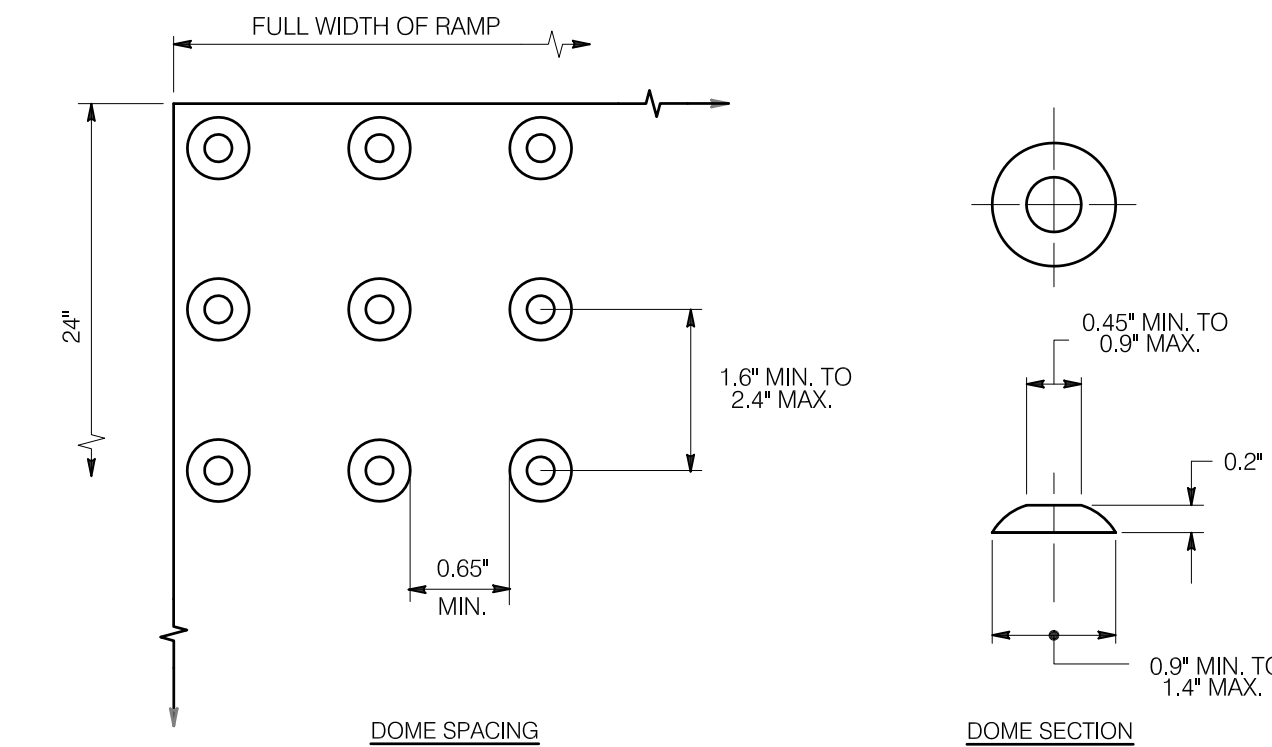

4 DETECTABLE WARNING STRIP
SCALE: N.T.S.

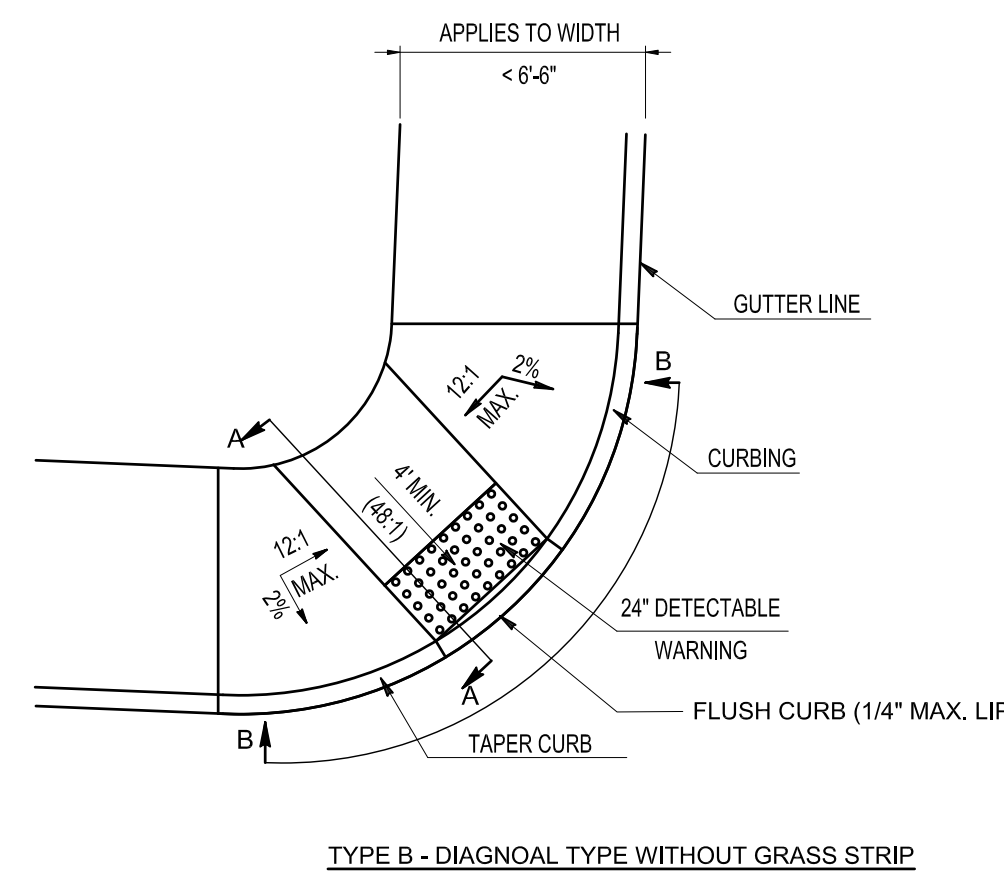

7 CURB RAMP AT STREET INTERSECTIONS
N.T.S.

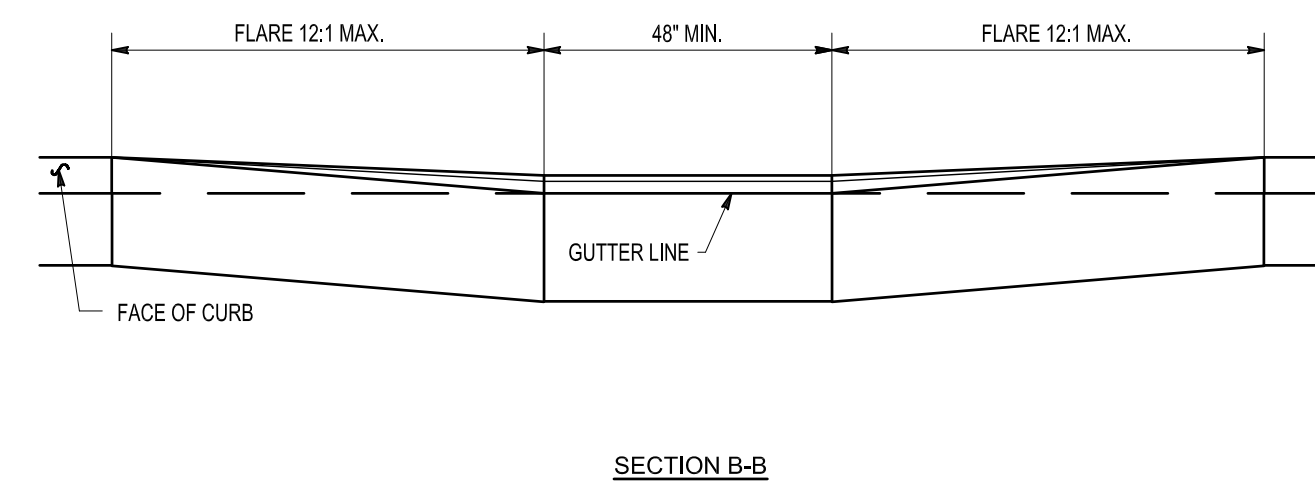

SECTION B-B

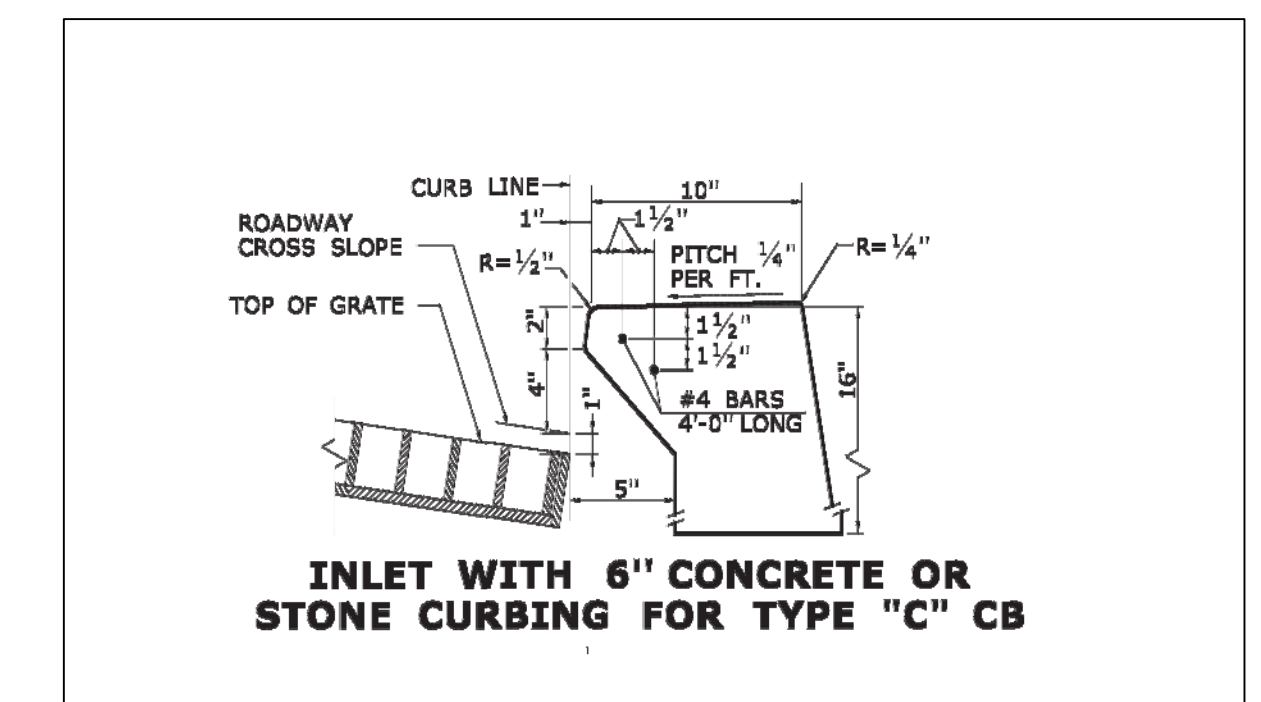

13 TYPE "C" CB TOP (STONE OR CONCRETE CURB)
SCALE: N.T.S.

NO.	DESCRIPTION	DATE

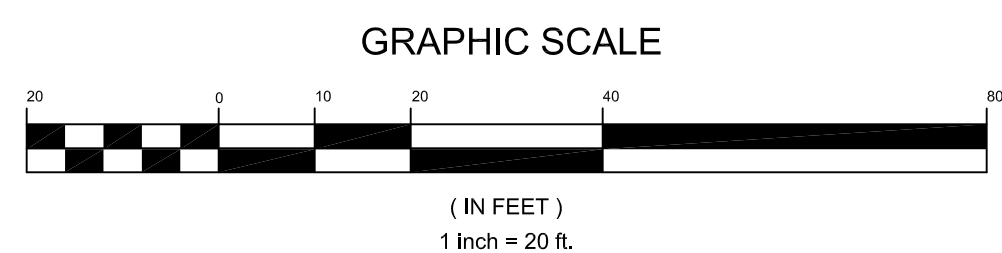

ENGINEERING CONSULTANT:

Cabezas DeAngelis
ENGINEERS & SURVEYORS

78 ELM STREET, BRIDGEPORT, CT 06604
P: 203 330 8700 • F: 203 330 8701

APPROVED BY:

MAREK KEMENT, P.E.
DIRECTOR OF ENGINEERING

WEST MAIN STREET (S.R. 68 & 70)
STREETSCAPE IMPROVEMENTS PROJECT
(PHASE 3 - WILLOW STREET CORRIDOR)
FROM WEST MAIN STREET TO #31 WILLOW STREET
DEPARTMENT OF PUBLIC WORKS
CHESHIRE, CONNECTICUT

DESIGNED CAD
DRAWN CAD
CHECKED CAD
SCALE AS SHOWN
DATE 09-09-2022

DRAWING NO. 02
JOB NO. 22.16
CONTRACT NO. -----
SHEET 2 OF 5 SHEETS

TOWN OF CHESHIRE
TYPICAL SITE DETAILS
DEPARTMENT OF PUBLIC WORKS

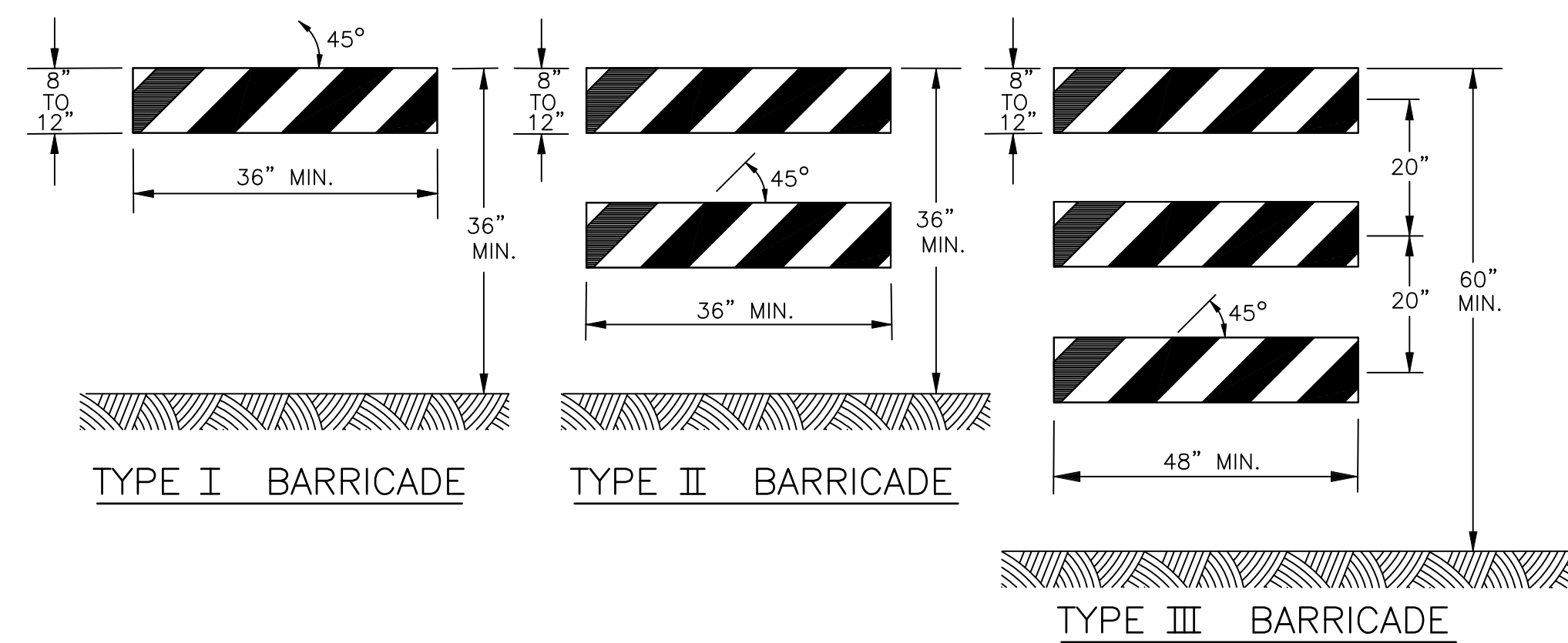

CONSTRUCTION BARRICADES

NOTES:

- MARKINGS FOR BARRICADE RAILS SHALL BE ALTERNATE ORANGE AND WHITE STRIPES SLOPING DOWNWARD IN THE DIRECTION TRAFFIC IS TO PASS. 6" WIDE STRIPES SHALL BE USED.
- THE ENTIRE AREA OF ORANGE AND WHITE STRIPES SHALL BE REFLECTIVE SHEETING AS REQUIRED IN THE SPECIFICATIONS. RAILS FOR TYPE I AND TYPE II BARRICADES SHALL BE REFLECTORIZED ON BOTH SIDES. WHERE TRAFFIC PASSES ONLY IN ONE DIRECTION OF TRAVEL, ONLY THE SIDE FACING TRAFFIC SHALL BE REFLECTORIZED.
- THE ENGINEER RESERVES THE RIGHT TO REJECT ANY BARRICADE DEEMED A HAZARD, OR NOT IN THE BEST INTEREST OF THE MOTORING PUBLIC.
- CORNERS OF ALUMINUM BARRICADE RAILS SHALL BE ROUNDED.

NOTES:

SUPPORTS SHALL BE METAL SIGN POSTS AND HAVE BREAK-AWAY FEATURES. SEE TYPICAL CT DOT SHEETS.
 "TYPICAL SIGN SUPPORT AND SIGN PLACEMENT DETAILS"
 "TYPICAL METAL SIGN POSTS FOR SIGN FACE SHEET ALUMINUM"

NOTES:

- TRAFFIC DRUM SHALL BE DESIGNED IN ACCORDANCE WITH THE LATEST EDITION OF THE MUTCD.
- THE ENGINEER RESERVES THE RIGHT TO REJECT ANY DRUM DEEMED UNSUITABLE FOR THE PURPOSE INTENDED, AS REQUIRED IN THE SPECIFICATIONS.
- THE ENTIRE AREA OF ORANGE AND WHITE STRIPES SHALL BE REFLECTIVE SHEETING.
- REFLECTORIZED STRIPES SHOULD NOT BE PLACED OVER THE PROTRUDING CIRCUMFERENCIAL RIBS OF DRUMS.
- THE SECTIONS OF DRUMS NOT COVERED WITH REFLECTORIZED STRIPES SHALL BE ORANGE.
- THE DESIGN OF THE DRUM WILL ALLOW FOR ATTACHMENT OF A BARRICADE WARNING LIGHT.

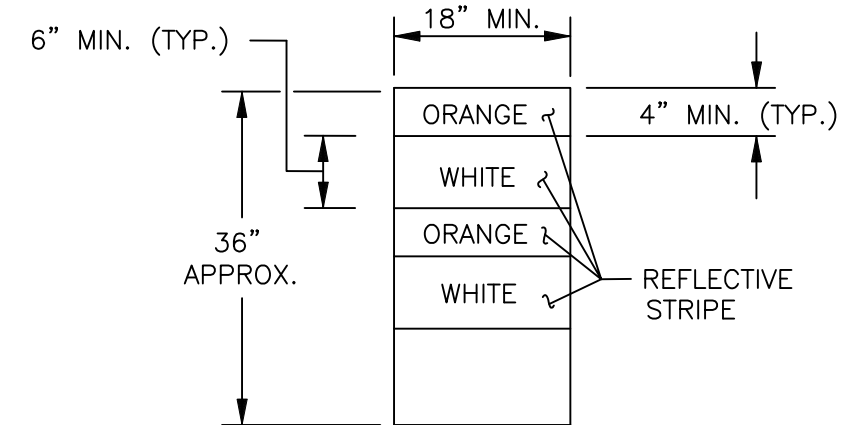

TRAFFIC DRUM (FRONT VIEW)



W20-1 (36" X 36")



W20-5D (36" X 36")

TYP. CONSTRUCTION SIGNS

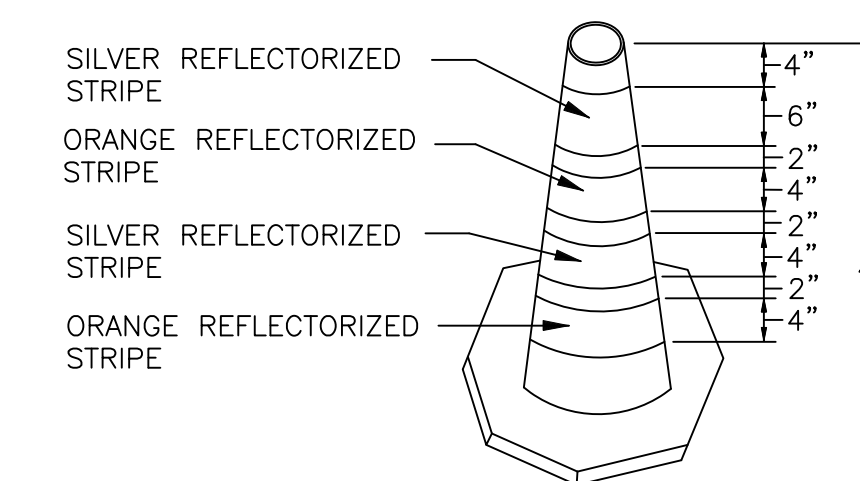

42" HIGH TRAFFIC CONE

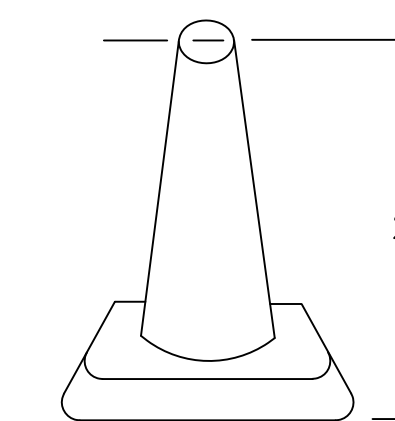

28" HIGH TRAFFIC CONE

NOTES:

- TRAFFIC CONES SHALL BE DESIGNED IN ACCORDANCE WITH THE MUTCD, CHAPTER VI, CONE DESIGN.
- CONES SHALL BE PREDOMINATELY FEDERAL ORANGE IN COLOR AND REFLECTORIZED AS REQUIRED IN THE SPECIFICATIONS.
- RUBBER CONES SHALL HAVE INTERIOR RIBS FOR RIGIDITY.
- PLASTIC CONES SHALL BE COLOR IMPREGNATED.
- CONES SHALL BE OF A THICKNESS NECESSARY TO WITHSTAND IMPACT WITHOUT DAMAGE TO EITHER CONE OR IMPACTING VEHICLE.
- THE ENGINEER RESERVES THE RIGHT TO REJECT ANY CONE DEEMED UNSUITABLE FOR THE PURPOSE INTENDED.

NOTES:

- SIGN COLORS:
BACKGROUND - ORANGE, REFLECTORIZED ENCAPSULATED LENS
LEGEND - BLACK PLAIN
- SIGNS SHOWN ARE TYPICAL FOR CONSTRUCTION. OTHER SIGNS MAY BE NECESSARY AS ORDERED BY THE ENGINEER.
- FOR SPECIFIC SIGN DESIGN, REFER TO CONN. DEPARTMENT OF TRANSPORTATION DIVISION OF TRAFFIC DETAILED DRAWINGS.

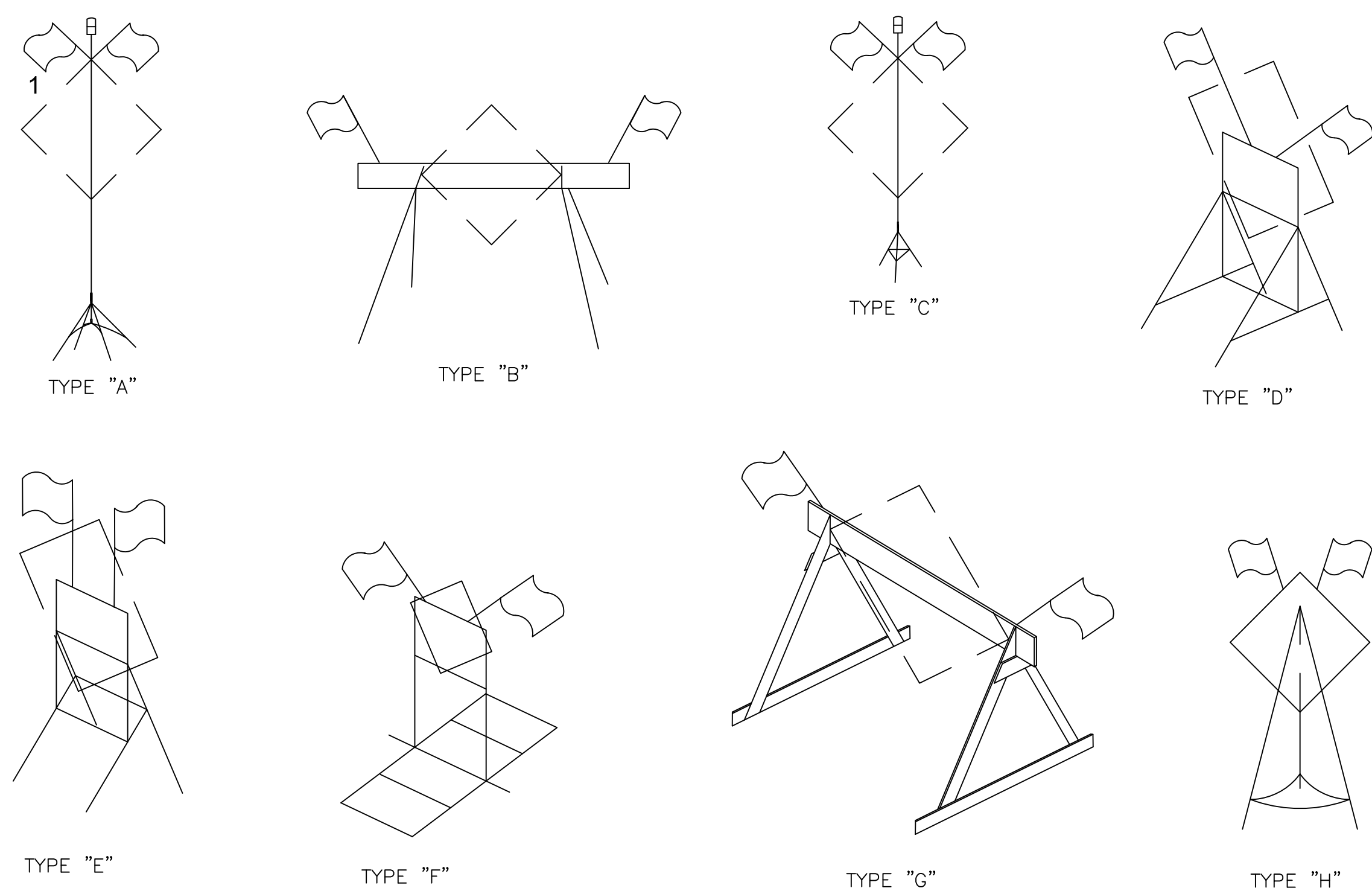

PORTABLE SIGN SUPPORTS

NOTES:

- SIGN SUPPORTS SHALL BE CONSTRUCTED OF A SUITABLE MATERIAL, BREAK-AWAY AND/OR COLLAPSIBLE FEATURES SHALL BE INCORPORATED IN THE DESIGN SO THAT THE SUPPORT WILL NOT CONSTITUTE A HAZARD TO THE MOTORIST AND/OR WORKERS IN THE WORK AREA.
- MOUNTING HEIGHT OF SIGN UTILIZING STRUCTURES DEPICTED ABOVE SHALL BE A MINIMUM OF 12", WITH A RECOMMENDED HEIGHT OF 18" ABOVE PAVEMENT.
- WHEN CALLED FOR ON THE PLANS OR DIRECTED BY THE ENGINEER, THE MOUNTING HEIGHT OF SIGNS ON PORTABLE SUPPORTS SHALL BE NOT LESS THAN 48" ABOVE THE PAVEMENT.
- THE ENGINEER RESERVES THE RIGHT TO REJECT ANY SUPPORT DEEMED A HAZARD OR NOT IN THE BEST INTEREST OF THE MOTORING PUBLIC.
- FLAGS AND/OR BARRICADE WARNING LIGHTS SHALL BE USED AS SHOWN ON THE TRAFFIC CONTROL PLANS AND AS DIRECTED BY THE ENGINEER.
- PORTABLE SIGN SUPPORTS SHALL BE STABILIZED WITH THE USE OF SANDBAGS OR OTHER APPROVED MEANS.

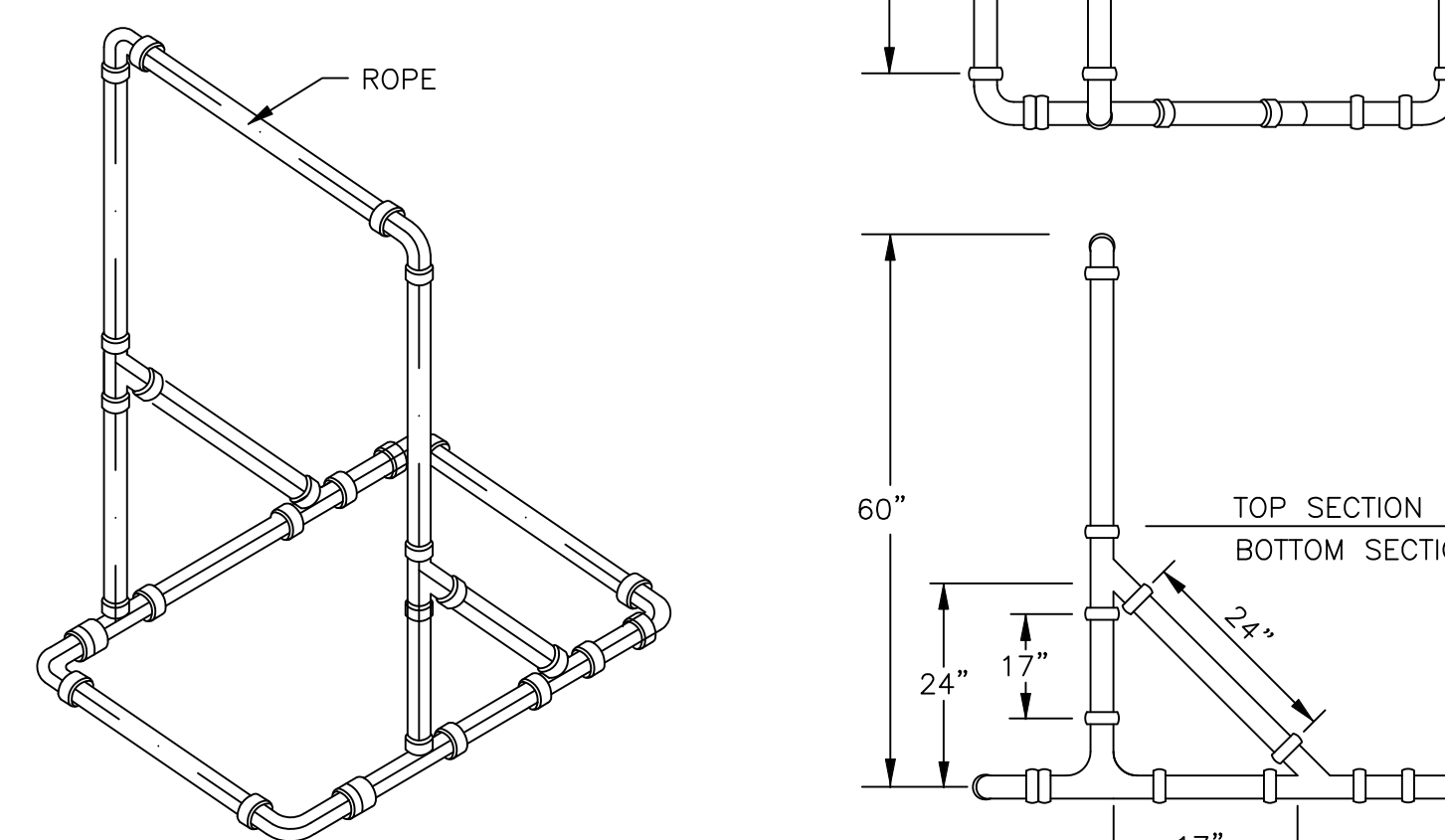

TYPICAL 3" DIA. OR 4" DIA. PLASTIC SIGN/BARRICADE SUPPORT

NOTES:

- DIMENSIONS ARE APPROXIMATE.
- BOTTOM SECTION MAY BE FILLED WITH SAND FOR BALLAST.
- SUPPORT SHALL BE LOOSELY THREADED WITH ROPE, KNOTTED AS REQUIRED.

MAINTENANCE AND PROTECTION OF TRAFFIC NOTES

- THE EXACT LOCATION OF ALL TRAFFIC CONTROL DEVICES IS TO BE DETERMINED IN THE FIELD BY THE ENGINEER.
- EXISTING CONFLICTING PAVEMENT MARKINGS OR SIGNAGE SHALL BE REMOVED OR COVERED, INCLUDING THOSE PAVEMENT MARKINGS OUTSIDE OF THE TRAVELWAY.
- THE CONTRACTOR SHALL KEEP A MINIMUM OF ONE MEANS OF EGRESS/INGRESS TO ALL DRIVEWAYS ALONG THE CONSTRUCTION LIMITS. THE CONTRACTOR SHALL COORDINATE HIS ACTIVITIES WITH INDIVIDUAL OWNERS SO AS TO PROVIDE THE LEAST DISTURBANCE POSSIBLE. INSTALL PROCESSED STONE DRIVES OR OTHER SUITABLE MATERIAL FOR TEMPORARY DRIVES AS DIRECTED BY THE ENGINEER.
- EXISTING SIGNS ARE TO BE RELOCATED AS NEEDED AND AS DIRECTED BY THE ENGINEER DURING CONSTRUCTION SO THAT THEY ARE IN THE APPROPRIATE LOCATION AND VISIBLE TO MOTORISTS. SOME SIGNS MAY HAVE TO BE TEMPORARILY LOCATED WITHIN THE WORK AREA.
- THE LOCATION OF TEMPORARY SIGNS SHOWN ON THE PLANS IS APPROXIMATE AND SHALL BE ADJUSTED BY THE CONTRACTOR TO MEET FIELD CONDITIONS.
- TEMPORARY SIGNS SHALL BE MOUNTED ON POSTS WHEN NECESSARY.
- THE LOCATION TRAFFIC DRUMS SHOWN ON THE PLANS ARE APPROXIMATE AND SHALL BE ADJUSTED BY THE CONTRACTOR TO MEET FIELD CONDITIONS AND TO CLEARLY DEFINE ACCESS TO AND EGRESS FROM ALL ROADWAYS AND DRIVEWAYS.
- CONTRACTOR SHALL MAINTAIN ACCESS TO INTERSECTION OF WEST MAIN STREET AND WILLOW STREET AT ALL TIMES. USE TRAFFIC OFFICERS WHEN WORKING IN STREET INTERSECTIONS.
- ALL EXCAVATIONS SHALL BE SUITABLY COVERED AT THE END OF EACH WORK DAY. UNDER NO CONDITIONS SHALL THE TRENCH OPENING BE LEFT OPEN DURING NON-WORKING HOURS.

NO.	DESCRIPTION	DATE
REVISIONS		

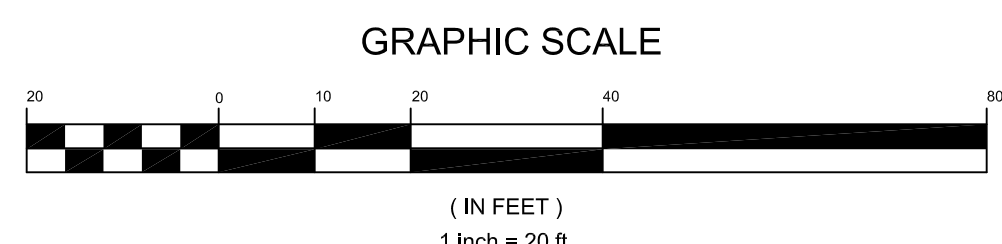

ENGINEERING CONSULTANT:
Cabezas DeAngelis
 ENGINEERS & SURVEYORS
 78 ELM STREET, BRIDGEPORT, CT 06604
 P: 203 330 8700 • F: 203 330 8701

APPROVED BY:
 MAREK KEMENT, P.E.
 DIRECTOR OF ENGINEERING

WEST MAIN STREET (S.R. 68 & 70)
 STREETScape IMPROVEMENTS PROJECT
 (PHASE 3 - WILLOW STREET CORRIDOR)
 FROM WEST MAIN STREET TO #31 WILLOW STREET
 DEPARTMENT OF PUBLIC WORKS
 CHESHIRE, CONNECTICUT

DESIGNED	DRAWN	CHECKED	SCALE	DATE
CAD	CAD	CAD	AS SHOWN	09-09-2022

DRAWING NO. **03**
 JOB NO. 22.16
 CONTRACT NO. _____
 SHEET 3 OF 5 SHEETS

TOWN OF CHESHIRE
TRAFFIC CONTROL DETAILS
 DEPARTMENT OF PUBLIC WORKS

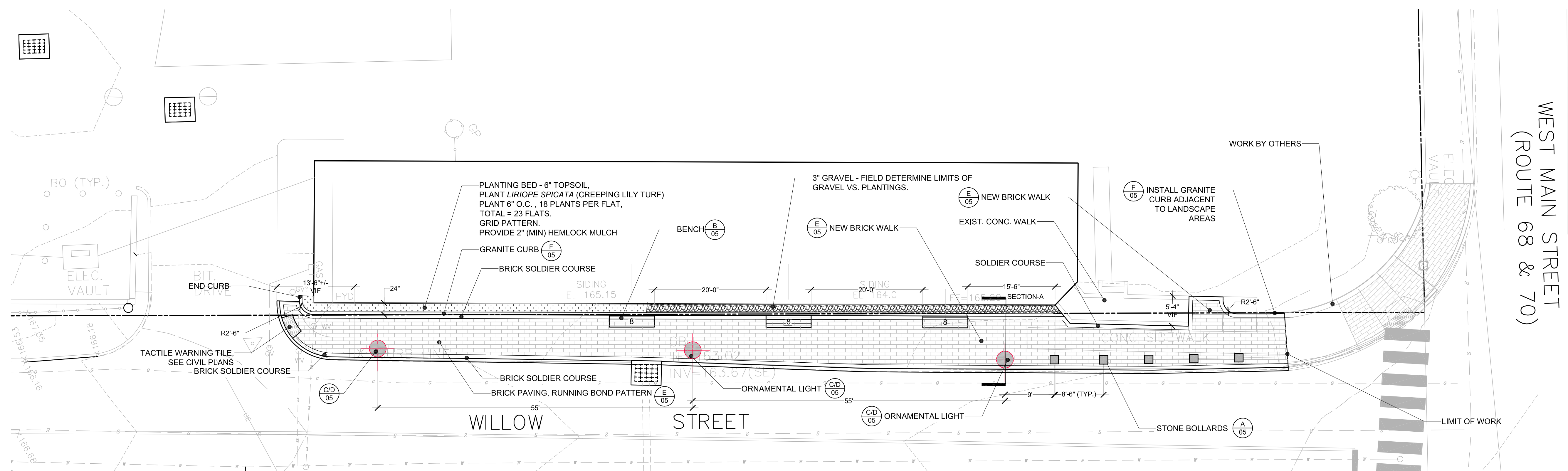

WEST MAIN STREET
(ROUTE 68 & 70)

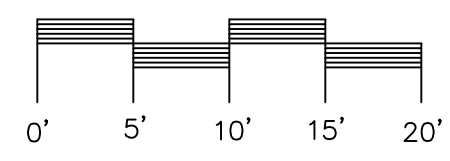
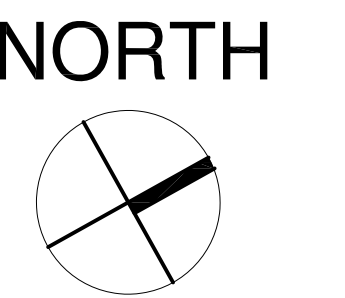

NO.	DESCRIPTION	DATE
	REVISIONS	

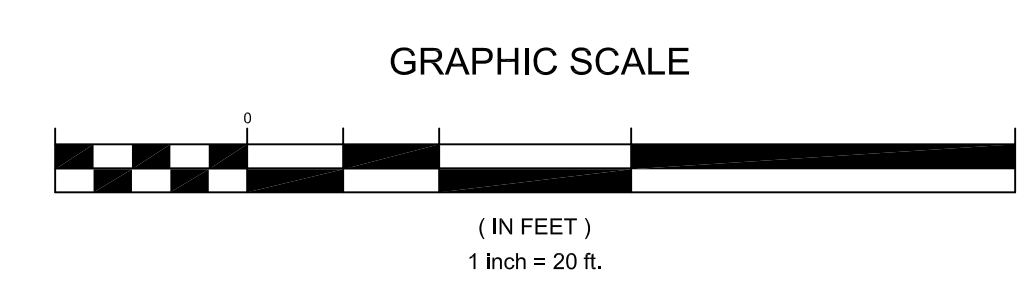

LANDSCAPE ARCHITECT
ARIS LAND STUDIO
Sustainability + Land Architecture
78 Elm Street
Bridgeport, CT 06604
www.arisls.com
203.606.3130

APPROVED BY:

MAREK KEMENT, P.E.
DIRECTOR OF ENGINEERING

WEST MAIN STREET (S.R. 68 & 70)
STREETSCAPE IMPROVEMENTS PROJECT
(PHASE 3 - WILLOW STREET CORRIDOR)
FROM WEST MAIN STREET TO #31 WILLOW STREET
DEPARTMENT OF PUBLIC WORKS
CHESHIRE, CONNECTICUT

DESIGNED: AWS
DRAWN: AWS
CHECKED: AWS
SCALE: 1" = 10'-0"
DATE: 09/09/22

DRAWING NO. **04**
JOB NO. 22-310
CONTRACT NO. _____

TOWN OF CHESHIRE
STREETSCAPE DETAIL PLAN
DEPARTMENT OF PUBLIC WORKS

SHEET 4 OF 5 SHEETS

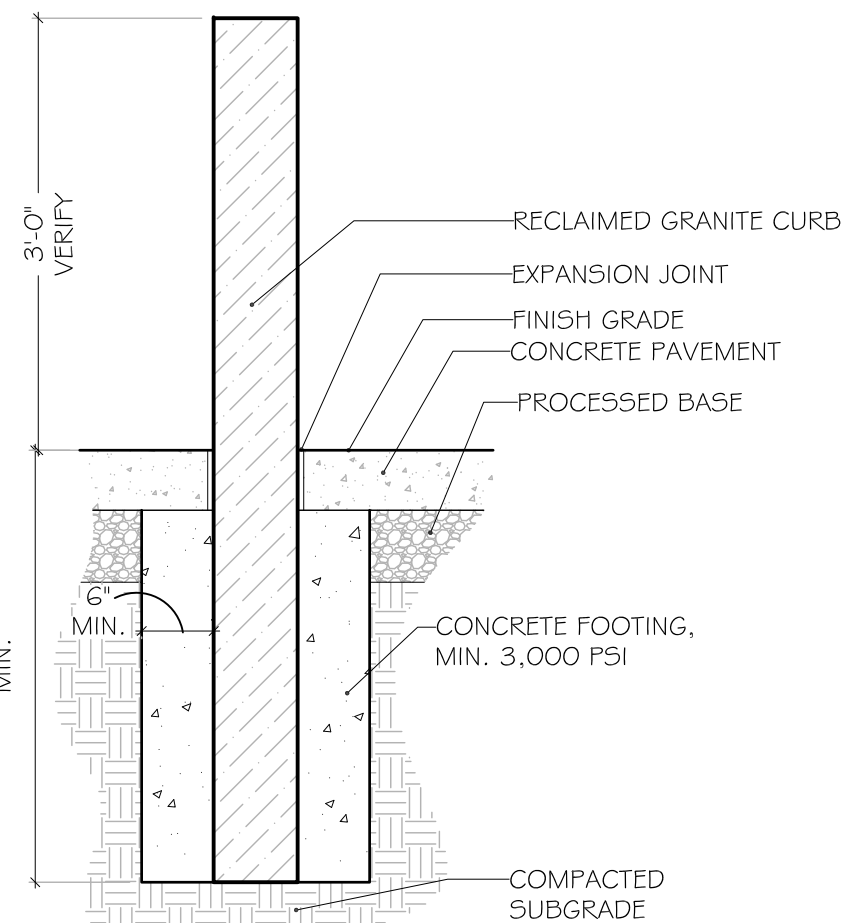

- NOTES:
1. GRANITE HITTING POST AS SUPPLIED BY SWENSON GRANITE, NEWTOWN, CT.
 2. GRANITE SHALL BE "EASTERN GRAY", 6" x 6", ROCK FACE 2 SIDES, THERMAL FINISH 2 SIDES, WITH HITTING RING.

A GRANITE BOLLARD
SCALE: 3/4" = 1'-0"

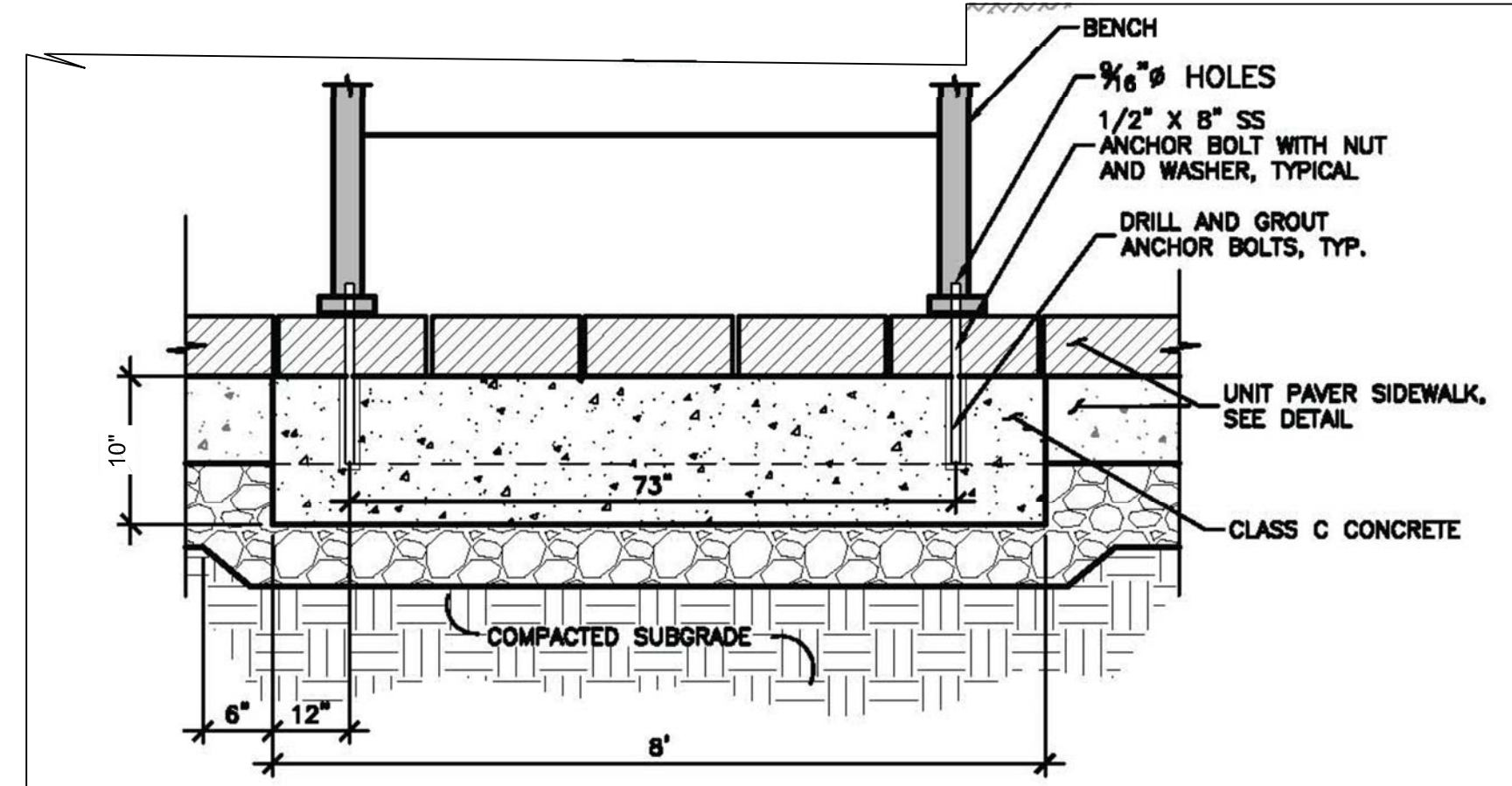

- NOTE:
1. 1/2" x 8" STAINLESS STEEL ANCHOR BOLTS & NUTS PROVIDED BY CONTRACTOR.

B SITE BENCH MOUNTING ON PAVERS
N.T.S.

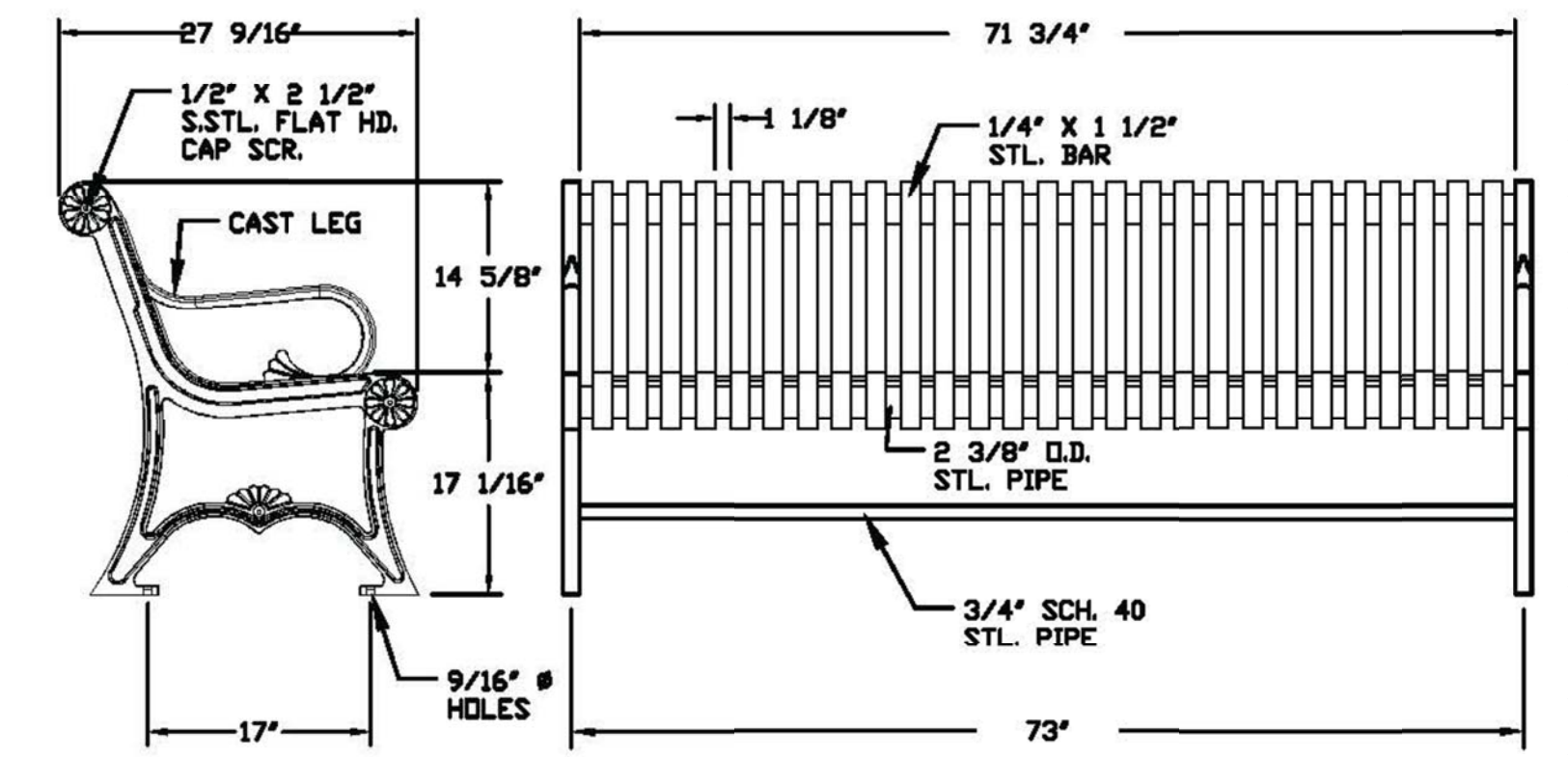

- NOTES:
1. INSTALL PER MANUFACTURER'S SPECIFICATIONS.
MODEL #58-80 (8' LENGTH)
COLOR: BLACK
MOUNTING: S-1 EMBEDMENT
MANUFACTURED BY DUMOR, INC.
P.O. BOX 142 MIFFLINTOWN, PA
17058-0142
(800)598-4018
OR APPROVED EQUAL

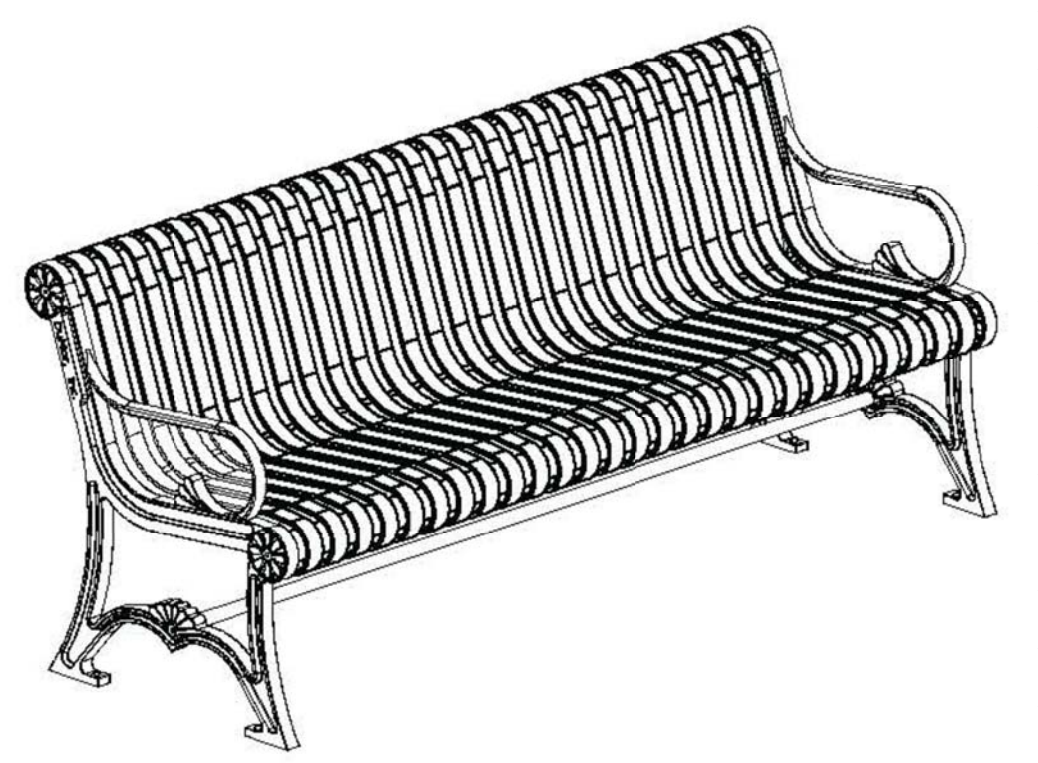

SITE BENCH
N.T.S.

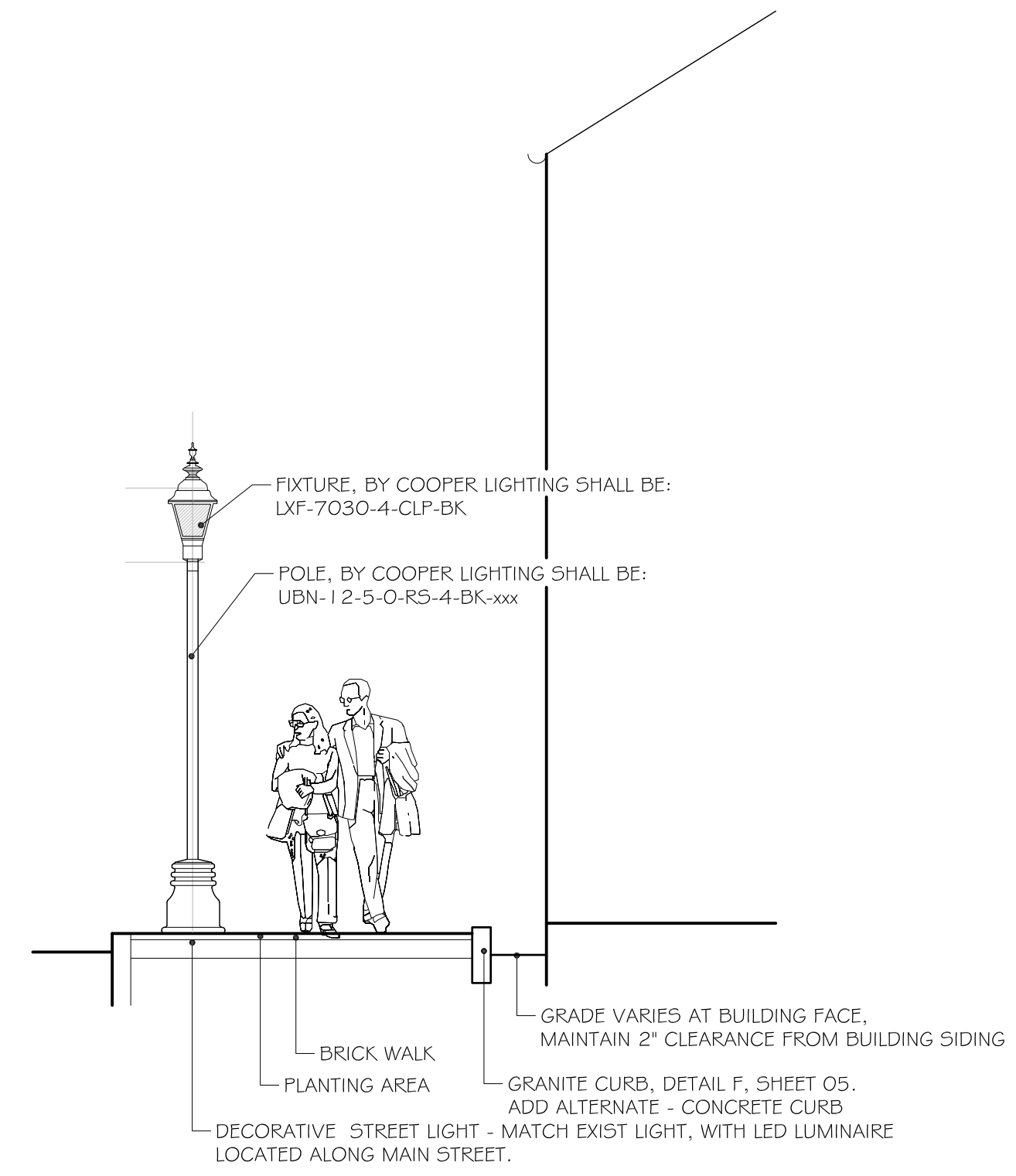

C SECTION WALK 'A'
SCALE 1/4" = 1'-0"

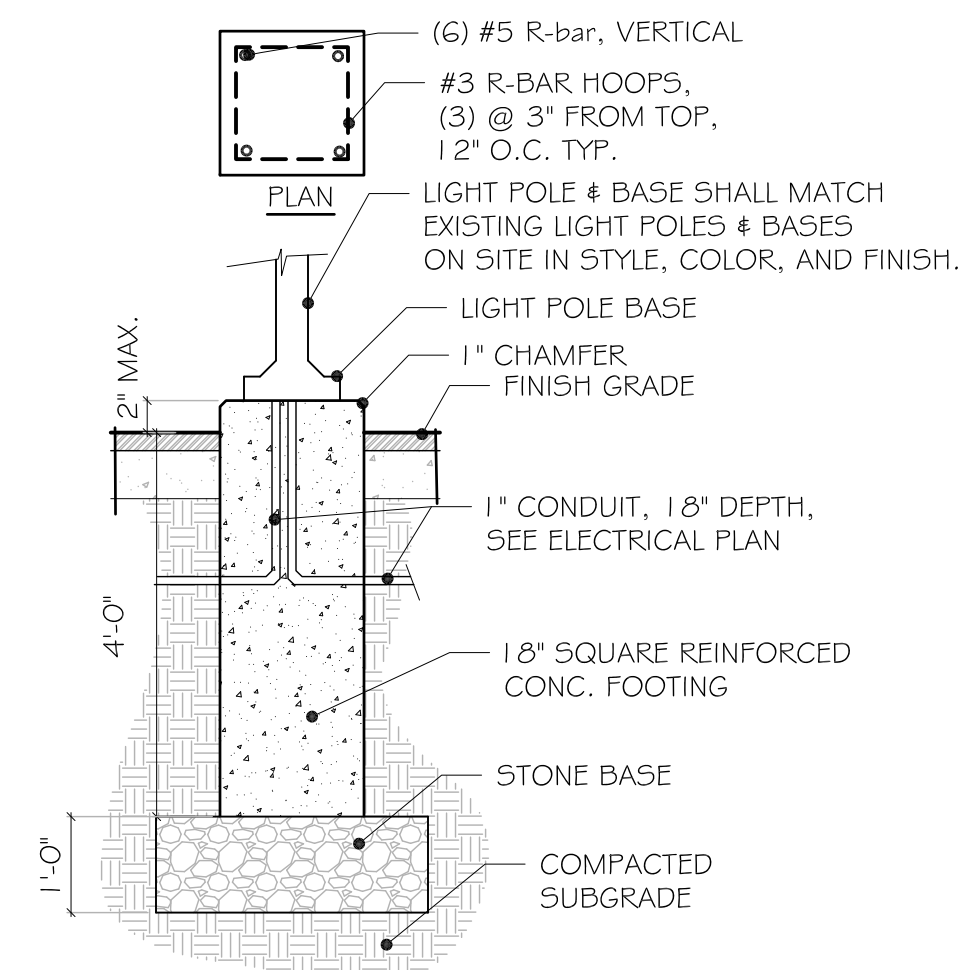

1. INSTALL BOLTS AND SECURE LIGHT PER MANUFACTURER'S RECOMMENDATIONS.
2. ELECTRICAL DESIGN / CONDUCTORS BY OTHERS. ALL WORK SHALL BE PERFORMED BY LICENSED ELECTRICIANS.
3. ALL WORK TO COMPLY WITH CURRENT ELECTRICAL CODES.

D LIGHT POLE FOOTING
N.T.S.

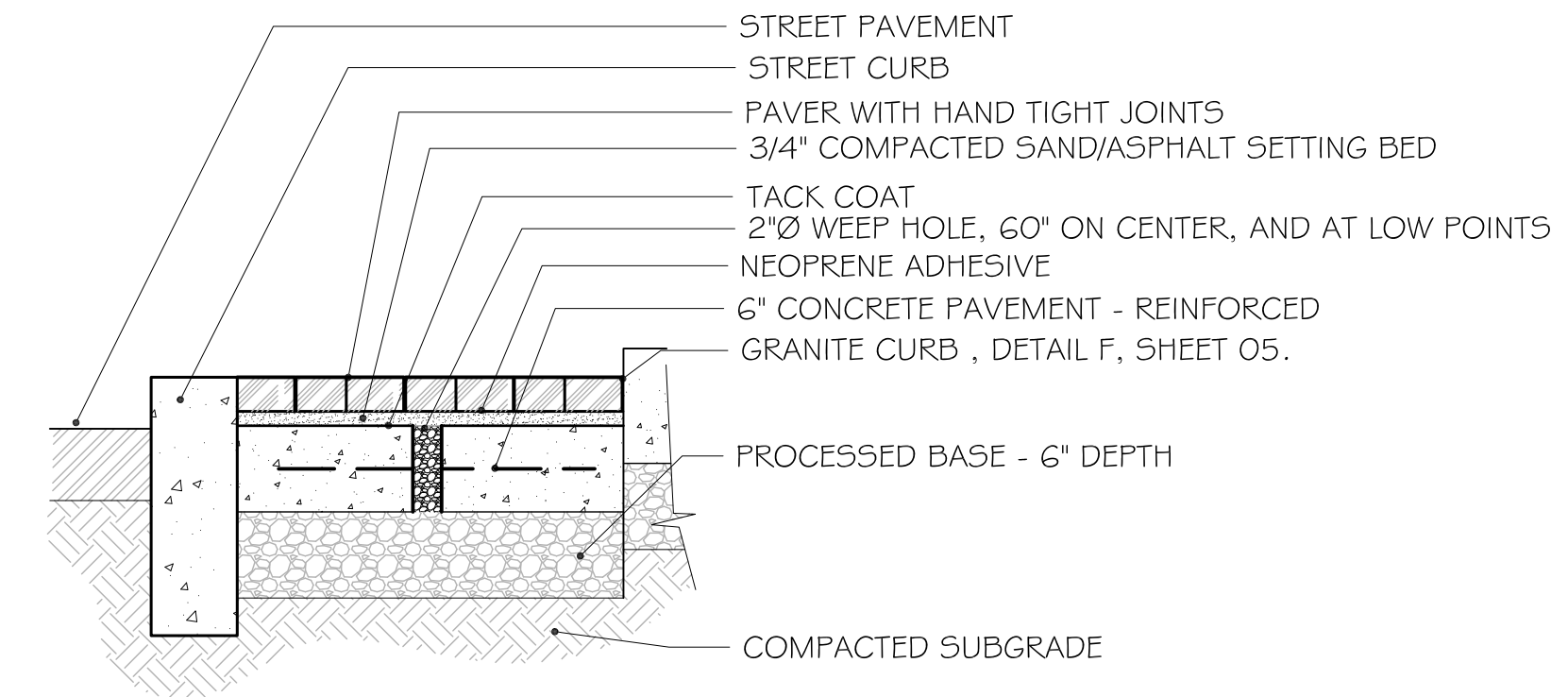

1. PAVERS SHALL BE BY BELDEN BRICK CO. (WWW.BELDENBRICK.COM). COLOR, STYLE TO BE DETERMINED.
2. FILL JOINTS WITH "GATOR SUPER SAND BOND" AS SUPPLIED BY ALLIANCE DESIGNER PRODUCTS, INC., OR EQUAL AS APPROVED BY LANDSCAPE ARCHITECT. INSTALL PER MANUFACTURER'S RECOMMENDATIONS.
3. INSTALL PAVERS IN A RUNNING BOND PATTERN. SEE PLAN FOR ADDITIONAL PATTERN DETAILS.
4. INSTALL AS RECOMMENDED BY MANUFACTURER.
5. CONTRACTOR SHALL RETURN AFTER 6 MONTHS TO TOPDRESS SURFACE OF PAVERS.

E PAVER DETAIL
N.T.S.

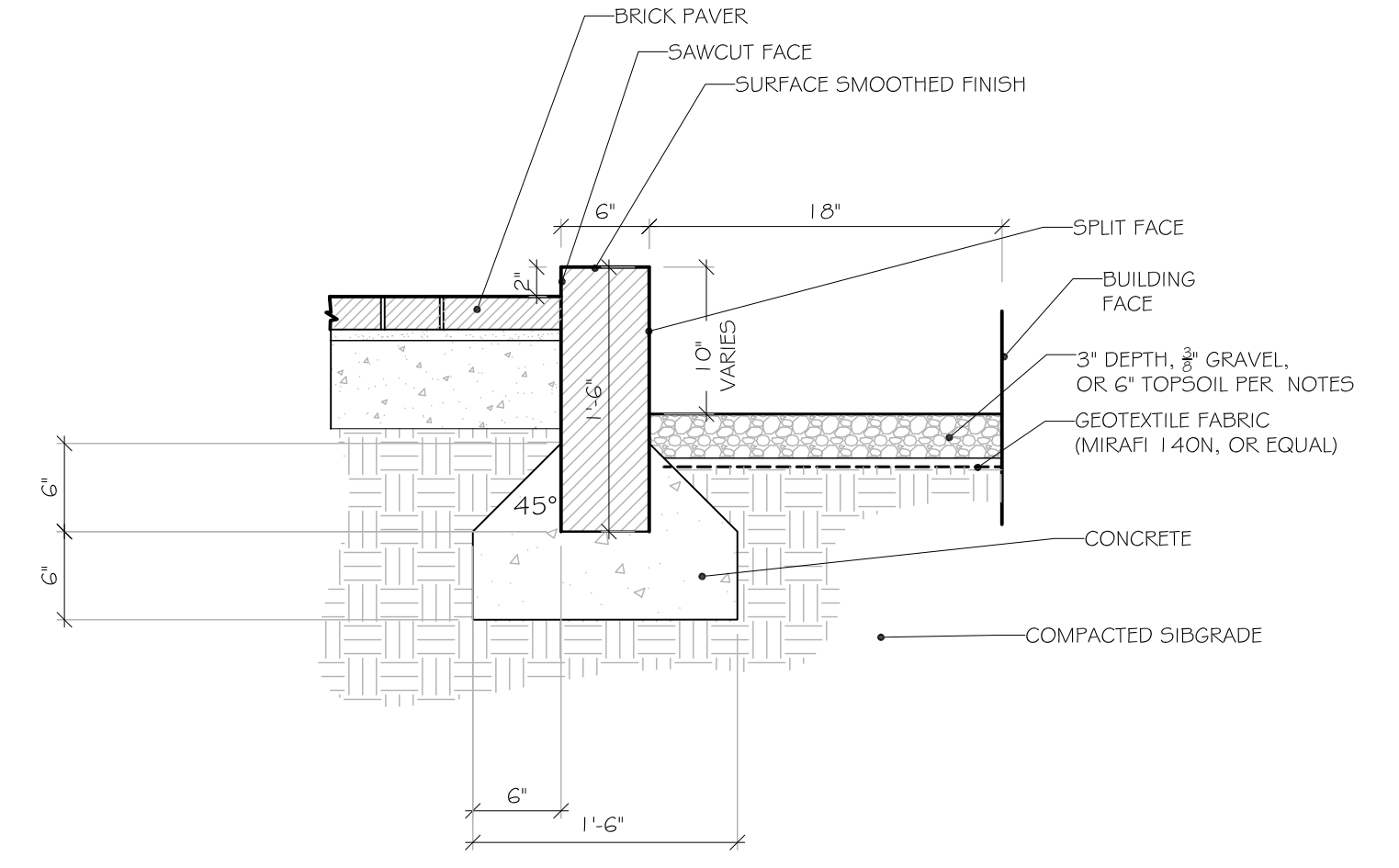

1. FIELD LOCATE LIMIT OF GRAVEL INSTALLATION VS. TOPSOIL AND PLANTING INSTALLATION.
2. GRAVEL / TOPSOIL SHALL BE SET 2" MINIMUM BELOW SIDING OF BUILDING.
3. GRANITE SHALL MATCH GRANITE STREET CURB.
4. SAWN CUT FACE OF CURB SHALL BE SET ADJACENT TO BRICK PAVERS.
5. SUBMIT ALTERNATE BID FOR CONCRETE CURB, IN LIEU OF GRANITE.

F GRANITE STONE CURB @ BUILDING
N.T.S.

NO.	DESCRIPTION	DATE

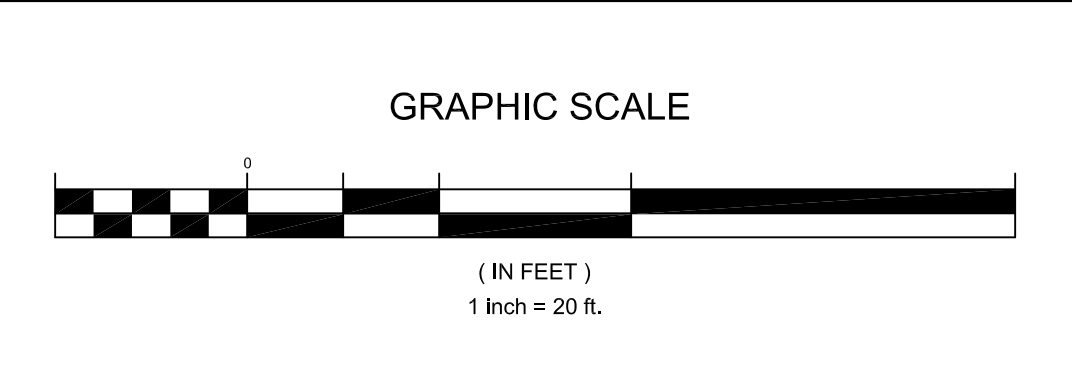

LANDSCAPE ARCHITECT

ARIS LAND STUDIO
Sustainability + Land Architecture

78 Elm Street
Bridgeport, CT 06604
www.arisls.com
203.606.3130

APPROVED BY:

MAREK KEMENT, P.E.
DIRECTOR OF ENGINEERING

WEST MAIN STREET (S.R. 68 & 70)
STREETSCAPE IMPROVEMENTS PROJECT
(PHASE 3 - WILLOW STREET CORRIDOR)
FROM WEST MAIN STREET TO #31 WILLOW STREET
DEPARTMENT OF PUBLIC WORKS
CHESHIRE, CONNECTICUT

DESIGNED: AWS
DRAWN: AWS
CHECKED: AWS
SCALE: 1" = 10'-0"
DATE: 09/09/22

DRAWING NO. **05**

JOB NO. 22-310

CONTRACT NO. _____

SHEET 5 OF 5 SHEETS

TOWN OF CHESHIRE

STREETSCAPE DETAILS

DEPARTMENT OF PUBLIC WORKS